

1. PART NO. EXPRESSION :

SSC 0604 3R3 YZF
 (a) (b) (c) (d)(e)(f)

(a) Series code

(b) Dimension code

(c) Inductance code : 3R3 = 3.30uH

(d) Tolerance code : Y = ± 30%

(e) Z : Standard part

(f) F : RoHS Compliant

2. CONFIGURATION & DIMENSIONS :

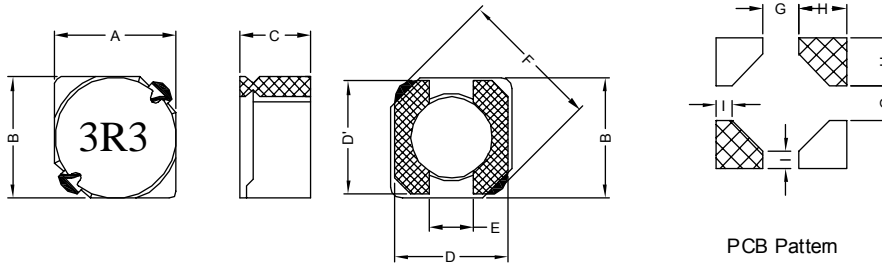

PCB Pattern

Unit:m/m

A	B	C	D	D'	E	F	G	H	I
6.70±0.3	6.70±0.3	4.00 Max.	6.50 Ref.	6.50 Ref.	2.00 Ref.	9.50 Max.	2.20 Ref.	2.55 Ref.	0.95 Ref.

3. SCHEMATIC :

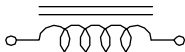

4. MATERIALS :

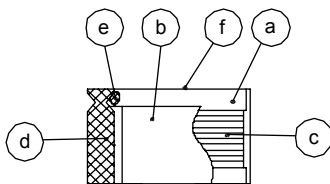

(a) DR Core

(b) RI Core

(c) Wire

(d) Terminal

(e) Adhesive

(f) Adhesive

(g) Ink

5. GENERAL SPECIFICATION :

- a) Temp. rise : 30° C Typ. at Rated Current
- b) ΔL/L0A : 35% Max. at Rated Current
- c) Operating temp. : -40° C to +125° C
- d) Storage condition (component in its packaging)
 - i) Temperature : -10 to 40° C
 - ii) Humidity : 60%
- e) Resistance to solder heat : 260° C.10 secs



RoHS Compliant

NOTE : Specifications subject to change without notice. Please check our website for latest information.

29.12.2014



SUPERWORLD ELECTRONICS (S) PTE LTD

6. ELECTRICAL CHARACTERISTICS :

Part No.	Inductance (μ H)	Test Frequency (Hz)	RDC (m Ω) Max.	IDC (A) Max.
SSC06043R3YZF	3.3 \pm 30%	0.5V / 10K	20	3.50
SSC06045R0YZF	5.0 \pm 30%	0.5V / 10K	24	2.90
SSC06046R2YZF	6.2 \pm 30%	0.5V / 10K	27	2.50
SSC06047R4YZF	7.4 \pm 30%	0.5V / 10K	31	2.30
SSC06048R7YZF	8.7 \pm 30%	0.5V / 10K	34	2.20
SSC0604100YZF	10.0 \pm 30%	0.5V / 10K	38	2.00
SSC0604120YZF	12.0 \pm 30%	0.5V / 10K	53	1.70
SSC0604150YZF	15.0 \pm 30%	0.5V / 10K	57	1.60
SSC0604180YZF	18.0 \pm 30%	0.5V / 10K	92	1.50
SSC0604220YZF	22.0 \pm 30%	0.5V / 10K	96	1.30
SSC0604270YZF	27.0 \pm 30%	0.5V / 10K	109	1.20
SSC0604330YZF	33.0 \pm 30%	0.5V / 10K	124	1.10
SSC0604390YZF	39.0 \pm 30%	0.5V / 10K	138	1.00
SSC0604470YZF	47.0 \pm 30%	0.5V / 10K	155	0.95
SSC0604560YZF	56.0 \pm 30%	0.5V / 10K	202	0.85
SSC0604680YZF	68.0 \pm 30%	0.5V / 10K	234	0.75
SSC0604820YZF	82.0 \pm 30%	0.5V / 10K	324	0.70
SSC0604101YZF	100.0 \pm 30%	0.5V / 10K	358	0.65



RoHS Compliant

NOTE : Specifications subject to change without notice. Please check our website for latest information.

29.12.2014



SUPERWORLD ELECTRONICS (S) PTE LTD

PG. 2

7. CHARACTERISTICS CURVES :

@ TEMP. RISE VS. DC SUPERPOSITION RESPONSE CURVE

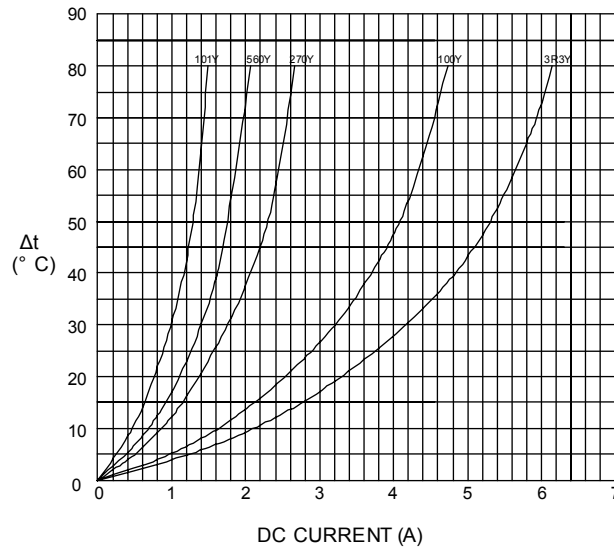

@ INDUCTANCE VS. FREQUENCY RESPONSE CURVE

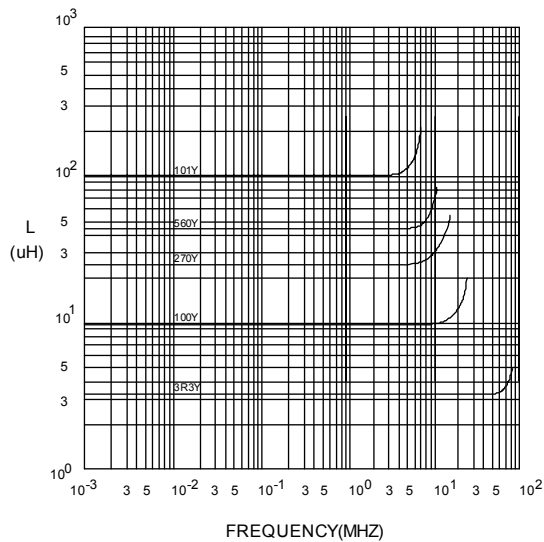

@ INDUCTANCE VS. DC SUPERPOSITION RESPONSE CURVE

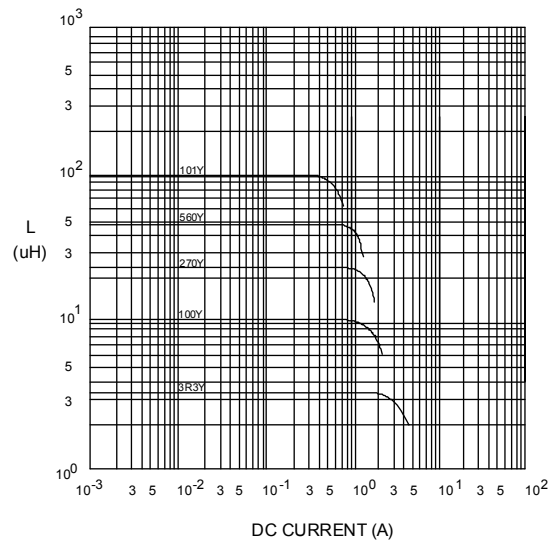

NOTE : Specifications subject to change without notice. Please check our website for latest information.



RoHS Compliant

29.12.2014



SUPERWORLD ELECTRONICS (S) PTE LTD

RECOMMENDED SOLDERING CONDITIONS REFLOW SOLDERINGS

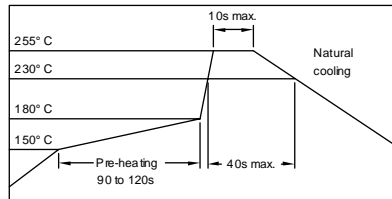

8. PACKAGING INFORMATION :

(1) CONFIGURATION

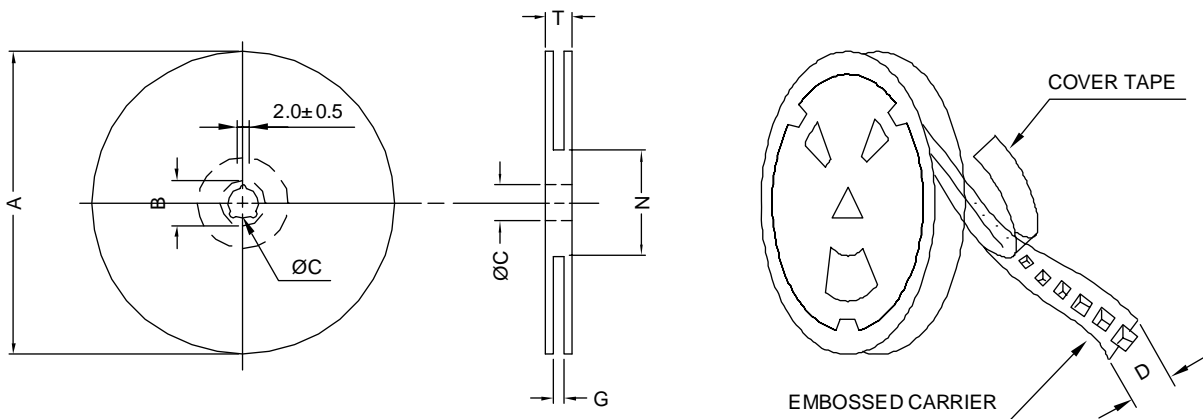

* CARRIER TAPE WIDTH : D

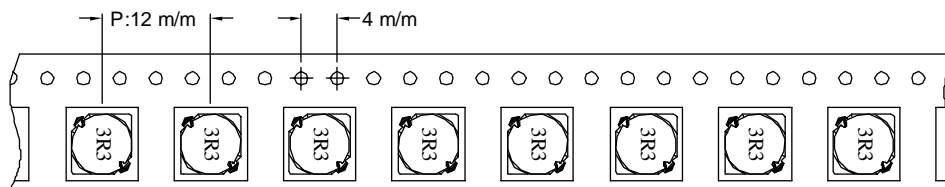

(2) DIMENSIONS

Unit:m/m

STYLE	A	B	C	D	G	N	T
13-16	330	21±0.8	13	16	18 +0	50 -0	22.4

(3) QTY & G.W. PER PACKAGE

SERIES	INNER : REEL			OUTER : CARTON		
	QTY (PCS)	G.W. (gw)	STYLE	QTY (PCS)	G.W. (Kg)	SIZE (cm)
SSC0604	1000	700	13-16	6000	7.7	38 x 36.5 x 21



RoHS Compliant

NOTE : Specifications subject to change without notice. Please check our website for latest information.

29.12.2014



SUPERWORLD ELECTRONICS (S) PTE LTD