

1. PART NO. EXPRESSION :

SSC0603 3R0 YZF
 (a) (b) (c) (d)(e)(f)

- (a) Series code
- (b) Dimension code
- (c) Inductance code : 3R0 = 3.00uH
- (d) Tolerance code : Y = ± 30%
- (e) Z : Standard part
- (f) F : RoHS Compliant

2. CONFIGURATION & DIMENSIONS :

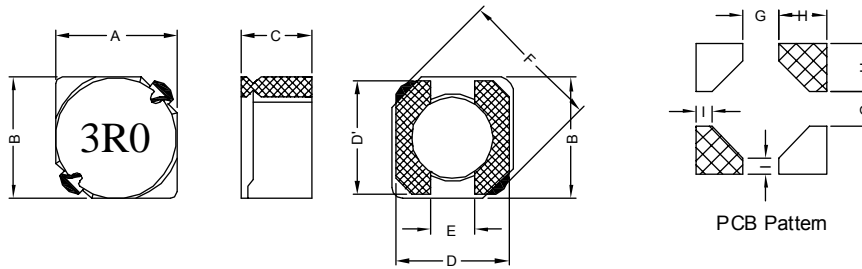

Unit:m/m

A	B	C	D	D'	E	F	G	H	I
6.70±0.3	6.70±0.3	3.00 Max.	6.50 Ref.	6.50 Ref.	2.00 Ref.	9.50 Max.	2.20 Ref.	2.55 Max.	0.95 Max.

3. SCHEMATIC :

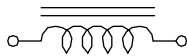

4. MATERIALS :

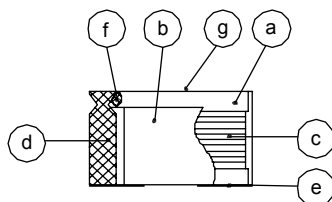

- (a) DR Core
- (b) RI Core
- (c) Wire
- (d) Terminal
- (e) Adhesive
- (f) Adhesive
- (g) Ink

5. GENERAL SPECIFICATION :

- a) Temp. rise : 30° C Typ. at Rated Current
- b) ΔL/L0A : 35% Max. at Rated Current
- c) Operating temp. : -40° C to +95° C
- d) Storage condition (component in its packaging)
 - i) Temperature : -10 to 40° C
 - ii) Humidity : 60%
- e) Resistance to solder heat : 260° C.10 secs



RoHS Compliant

NOTE : Specifications subject to change without notice. Please check our website for latest information.



6. ELECTRICAL CHARACTERISTICS :

Part No.	Inductance (μ H)	Test Frequency (Hz)	RDC (m Ω) Max.	IDC (A) Max.
SSC06033R0YZF	3.0 \pm 30%	0.5V / 10K	24	3.00
SSC06033R9YZF	3.9 \pm 30%	0.5V / 10K	27	2.60
SSC06035R0YZF	5.0 \pm 30%	0.5V / 10K	31	2.40
SSC06036R0YZF	6.0 \pm 30%	0.5V / 10K	35	2.25
SSC06037R3YZF	7.3 \pm 30%	0.5V / 10K	54	2.10
SSC06038R6YZF	8.6 \pm 30%	0.5V / 10K	58	1.85
SSC0603100YZF	10.0 \pm 30%	0.5V / 10K	65	1.70
SSC0603120YZF	12.0 \pm 30%	0.5V / 10K	70	1.55
SSC0603150YZF	15.0 \pm 30%	0.5V / 10K	84	1.40
SSC0603180YZF	18.0 \pm 30%	0.5V / 10K	95	1.32
SSC0603220YZF	22.0 \pm 30%	0.5V / 10K	128	1.20
SSC0603270YZF	27.0 \pm 30%	0.5V / 10K	142	1.05
SSC0603330YZF	33.0 \pm 30%	0.5V / 10K	165	0.97
SSC0603390YZF	39.0 \pm 30%	0.5V / 10K	210	0.86
SSC0603470YZF	47.0 \pm 30%	0.5V / 10K	238	0.80
SSC0603560YZF	56.0 \pm 30%	0.5V / 10K	277	0.73
SSC0603680YZF	68.0 \pm 30%	0.5V / 10K	304	0.65
SSC0603820YZF	82.0 \pm 30%	0.5V / 10K	390	0.60
SSC0603101YZF	100.0 \pm 30%	0.5V / 10K	535	0.54



RoHS Compliant

NOTE : Specifications subject to change without notice. Please check our website for latest information.

29.12.2014



SUPERWORLD ELECTRONICS (S) PTE LTD

PG. 2

7. CHARACTERISTICS CURVES :

@ TEMP. RISE VS. DC SUPERPOSITION RESPONSE CURVE

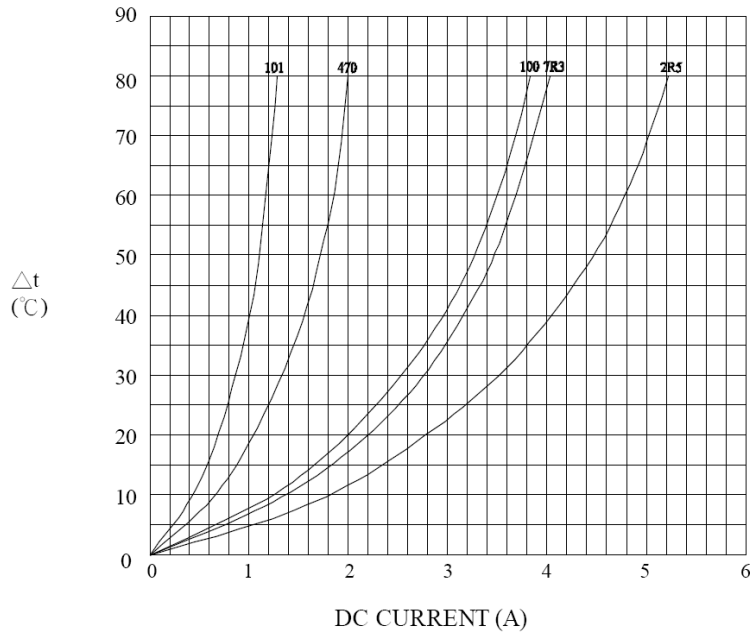

@ INDUCTANCE VS. FREQUENCY RESPONSE CURVE

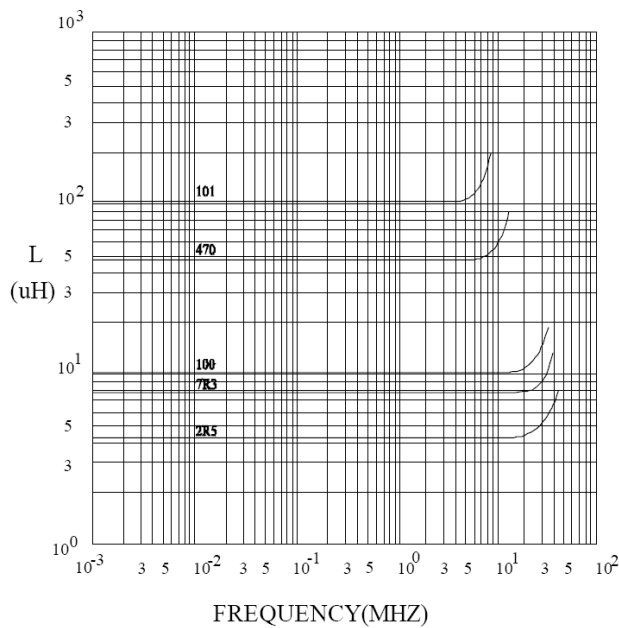

@ INDUCTANCE VS. DC SUPERPOSITION RESPONSE CURVE

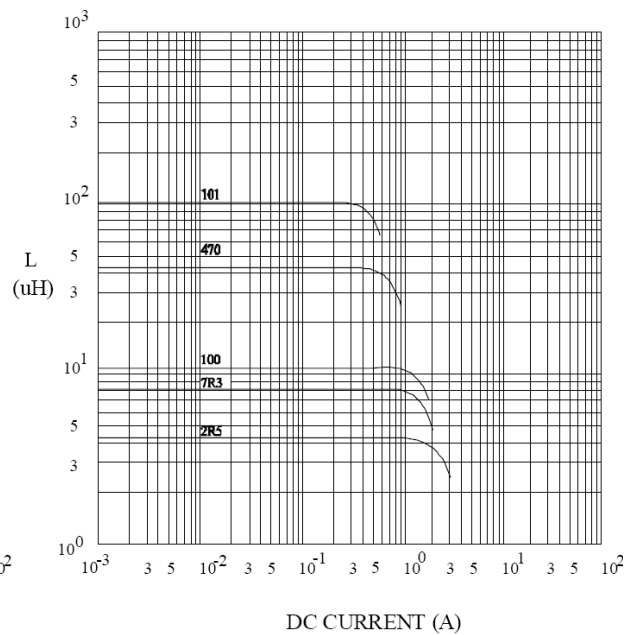

RoHS Compliant

NOTE : Specifications subject to change without notice. Please check our website for latest information.

29.12.2014



SUPERWORLD ELECTRONICS (S) PTE LTD

RECOMMENDED SOLDERING CONDITIONS REFLOW SOLDERINGS

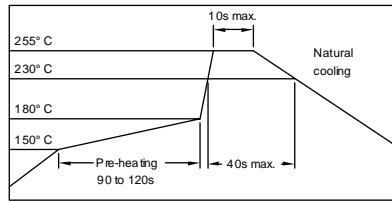

8. PACKAGING INFORMATION :

(1) CONFIGURATION

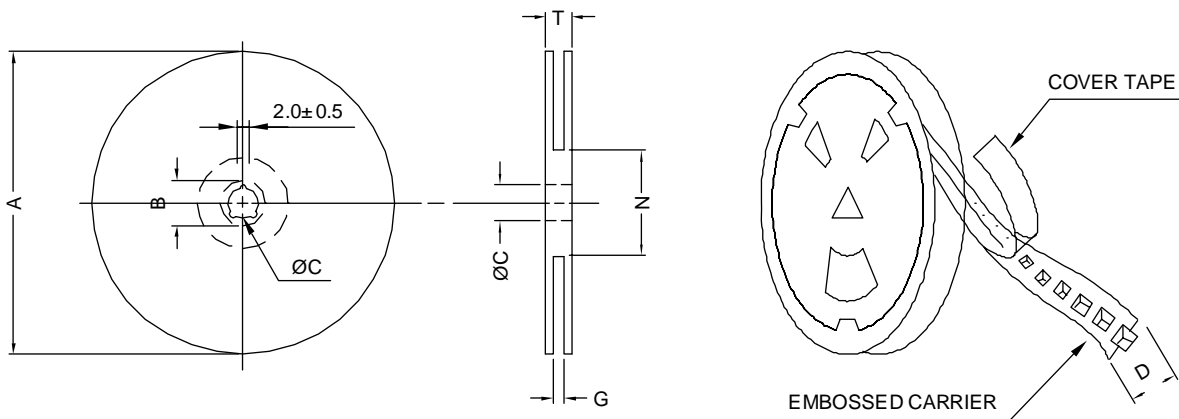

* CARRIER TAPE WIDTH : D

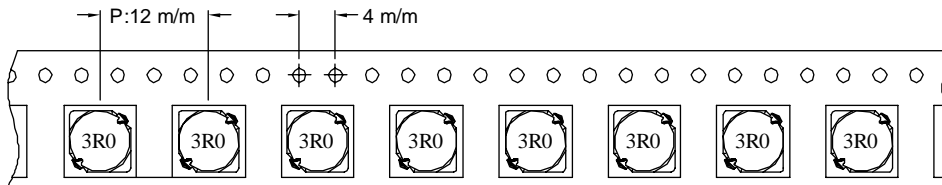

(2) DIMENSIONS

Unit:m/m

STYLE	A	B	C	D	G	N	T
13-16	330	21±0.8	13	16	18 ⁺⁰	50 ⁻⁰	22.4

(3) QTY & G.W. PER PACKAGE

SERIES	INNER : REEL			OUTER : CARTON		
	QTY (PCS)	G.W. (gw)	STYLE	QTY (PCS)	G.W. (Kg)	SIZE (cm)
SSC0603	1000	600	13-16	6000	7.1	38 x 36.5 x 21



RoHS Compliant

NOTE : Specifications subject to change without notice. Please check our website for latest information.

29.12.2014



SUPERWORLD ELECTRONICS (S) PTE LTD