

### 1. PART NO. EXPRESSION :

SSC 0503 2R5 YZF  
 (a) (b) (c) (d)(e)(f)

- (a) Series code
- (b) Dimension code
- (c) Inductance code : 2R5 = 2.5uH
- (d) Tolerance code : Y = ± 30%
- (e) Z : Standard part
- (f) F : RoHS Compliant

### 2. CONFIGURATION & DIMENSIONS :

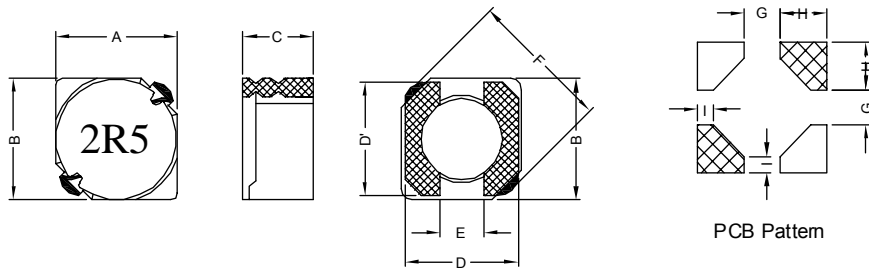

Unit : m/m

A	B	C	D	D'	E	F	G	H	I
5.70±0.3	5.70±0.3	3.00 Max.	5.50 Ref.	5.50 Ref.	2.00 Ref.	8.20 Max.	2.20 Ref.	2.05 Ref.	0.85 Ref.

### 3. SCHEMATIC :



### 4. MATERIALS :

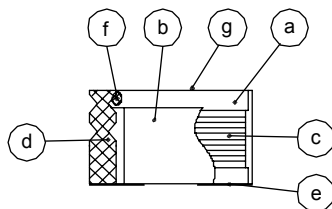

- (a) DR Core
- (b) RI Core
- (c) Wire
- (d) Terminal
- (e) Adhesive
- (f) Adhesive
- (g) Ink

### 5. GENERAL SPECIFICATION :

- a) Temp. rise : 30° C Max. at Rated Current
- b) Rated Current : Base on Temp. ΔL/L0A : 35% Max.
- c) Operating temp. : -40° C to +95° C
- d) Storage condition (component in its packaging)
  - i) Temperature : -10 to 40° C
  - ii) Humidity : 60%
- e) Resistance to solder heat : 260° C.10 secs



**RoHS Compliant**

NOTE : Specifications subject to change without notice. Please check our website for latest information.

29.12.2014



**SUPERWORLD ELECTRONICS (S) PTE LTD**

## 6. ELECTRICAL CHARACTERISTICS :

Part No.	Inductance ( $\mu$ H)	Test Frequency ( Hz )	RDC ( m $\Omega$ ) Max.	IDC ( A ) Max.
SSC05032R5YZF	2.5 $\pm$ 30%	0.5V / 10K	18	2.60
SSC05033R0YZF	3.0 $\pm$ 30%	0.5V / 10K	24	2.40
SSC05034R2YZF	4.2 $\pm$ 30%	0.5V / 10K	31	2.20
SSC05035R3YZF	5.3 $\pm$ 30%	0.5V / 10K	38	1.90
SSC05036R2YZF	6.2 $\pm$ 30%	0.5V / 10K	45	1.80
SSC05038R2YZF	8.2 $\pm$ 30%	0.5V / 10K	53	1.60
SSC0503100YZF	10.0 $\pm$ 30%	0.5V / 10K	65	1.30
SSC0503120YZF	12.0 $\pm$ 30%	0.5V / 10K	76	1.20
SSC0503150YZF	15.0 $\pm$ 30%	0.5V / 10K	103	1.10
SSC0503180YZF	18.0 $\pm$ 30%	0.5V / 10K	110	1.00
SSC0503220YZF	22.0 $\pm$ 30%	0.5V / 10K	122	0.90
SSC0503270YZF	27.0 $\pm$ 30%	0.5V / 10K	175	0.85
SSC0503330YZF	33.0 $\pm$ 30%	0.5V / 10K	189	0.75
SSC0503390YZF	39.0 $\pm$ 30%	0.5V / 10K	212	0.70
SSC0503470YZF	47.0 $\pm$ 30%	0.5V / 10K	250	0.62
SSC0503560YZF	56.0 $\pm$ 30%	0.5V / 10K	305	0.58
SSC0503680YZF	68.0 $\pm$ 30%	0.5V / 10K	355	0.52
SSC0503820YZF	82.0 $\pm$ 30%	0.5V / 10K	463	0.46
SSC0503101YZF	100.0 $\pm$ 30%	0.5V / 10K	520	0.42



RoHS Compliant

NOTE : Specifications subject to change without notice. Please check our website for latest information.

29.12.2014



SUPERWORLD ELECTRONICS (S) PTE LTD

PG. 2

7. CHARACTERISTICS CURVES :

@ TEMP. RISE VS. DC SUPERPOSITION RESPONSE CURVE

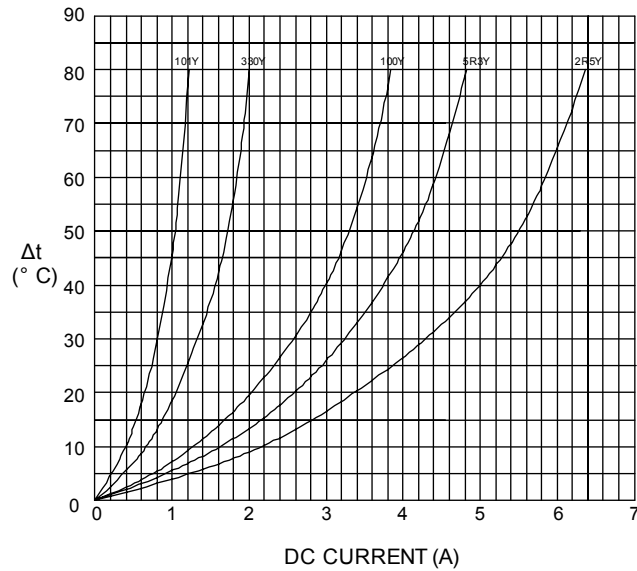

@ INDUCTANCE VS. FREQUENCY RESPONSE CURVE

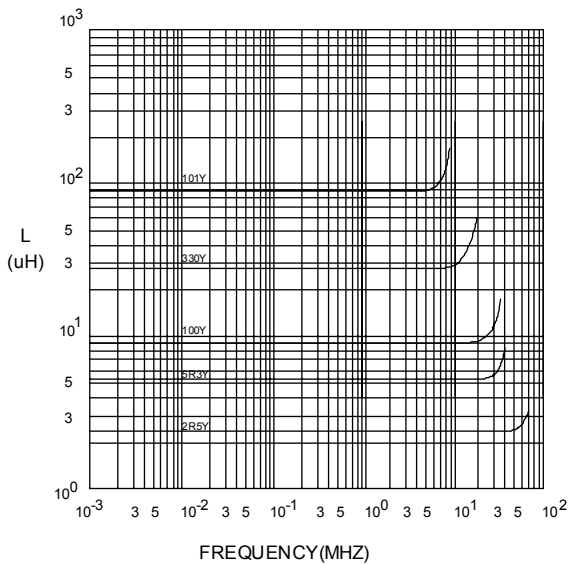

@ INDUCTANCE VS. DC SUPERPOSITION RESPONSE CURVE

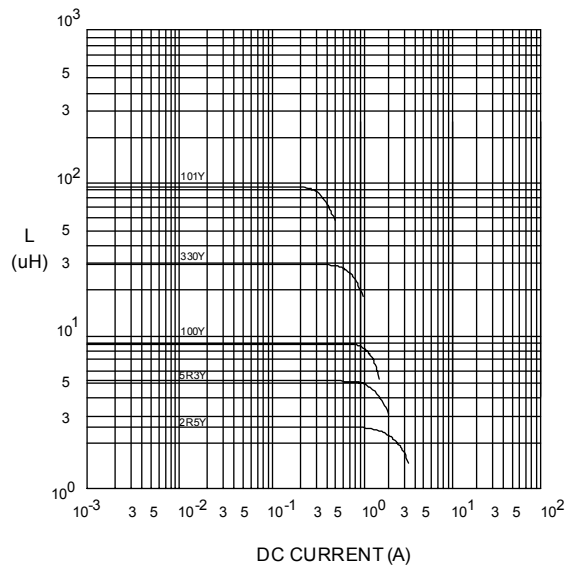

NOTE : Specifications subject to change without notice. Please check our website for latest information.



RoHS Compliant

29.12.2014



### RECOMMENDED SOLDERING CONDITIONS REFLOW SOLDERINGS

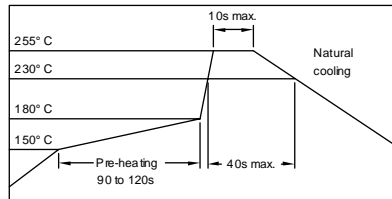

### 8. PACKAGING INFORMATION :

#### ( 1 ) CONFIGURATION

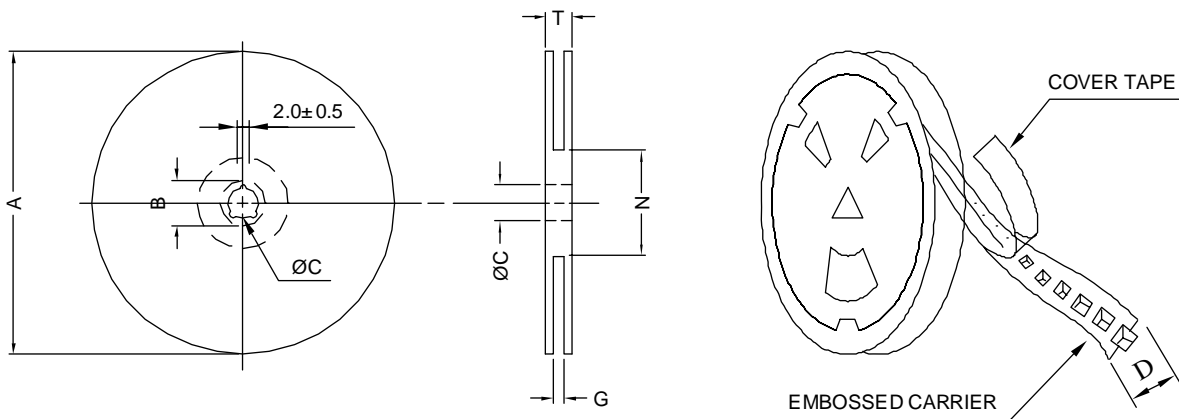

\* CARRIER TAPE WIDTH : D

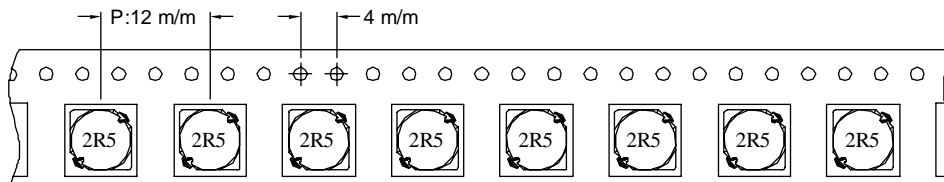

#### ( 2 ) DIMENSIONS

Unit:m/m

STYLE	A	B	C	D	G	N	T
13-16	330	21±0.8	13	16	18 <sup>+0</sup>	50 <sup>-0</sup>	22.4

#### ( 3 ) QTY & G.W. PER PACKAGE

SERIES	INNER : REEL			OUTER : CARTON		
	QTY (PCS)	G.W. (gw)	STYLE	QTY (PCS)	G.W. (Kg)	SIZE (cm)
SSC0503	1500	1800	13-16	9000	14.3	40 x 40 x 24



**RoHS Compliant**

NOTE : Specifications subject to change without notice. Please check our website for latest information.

29.12.2014



**SUPERWORLD ELECTRONICS (S) PTE LTD**