

### 1. PART NO. EXPRESSION :

SSB 0603 101 M Z F  
 (a) (b) (c) (d)(e)(f)

- (a) Series code
- (b) Dimension code
- (c) Inductance code : 101 = 100uH
- (d) Tolerance code : M = ±20%
- (e) Z : Standard part
- (f) F : RoHS Compliant

### 2. CONFIGURATION & DIMENSIONS :

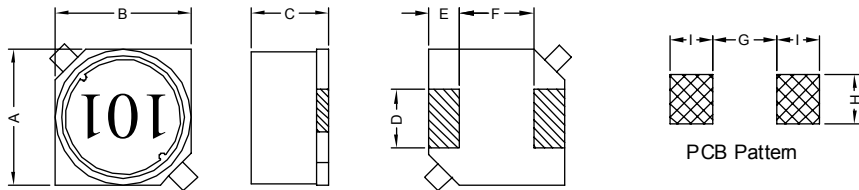

Unit:m/m

| A       | B       | C         | D       | E       | F       | G        | H        | I        |
|---------|---------|-----------|---------|---------|---------|----------|----------|----------|
| 6.0±0.3 | 6.0±0.3 | 2.90 Max. | 2.0±0.2 | 1.5±0.2 | 3.0±0.2 | 2.8 Ref. | 2.2 Ref. | 1.9 Ref. |

### 3. SCHEMATIC :

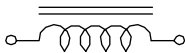

### 4. MATERIALS :

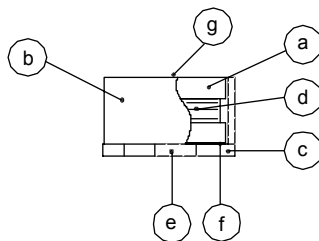

- (a) DR Core
- (b) RI Core
- (c) Base
- (d) Wire
- (e) Terminal
- (f) Adhesive
- (g) Ink

### 5. GENERAL SPECIFICATION :

- a) Temp. rise : 40° C Max.
- b) Rated current : Base on temp. rise & ΔL/L0A = 10% Max.
- c) Operating temp. : -40° C to +85° C
- d) Storage condition (component in its packaging)
  - i) Temperature : -10 to 40° C
  - ii) Humidity : 60%
- e) Resistance to solder heat : 260° C.10 secs



**RoHS Compliant**

NOTE : Specifications subject to change without notice. Please check our website for latest information.

22.12.2014

## 6. ELECTRICAL CHARACTERISTICS :

| Part No.      | Inductance<br>( $\mu$ H) | Q<br>Ref. | Test<br>Frequency<br>( Hz ) | SRF<br>( MHz )<br>Typ. | RDC<br>( m $\Omega$ )<br>Max. | IDC<br>( A )<br>Max. |
|---------------|--------------------------|-----------|-----------------------------|------------------------|-------------------------------|----------------------|
| SSB06031R0MZF | 1.0 $\pm$ 20%            | 30        | 1V / 100K                   | 190.0                  | 19                            | 2.40                 |
| SSB06031R5MZF | 1.5 $\pm$ 20%            | 30        | 1V / 100K                   | 140.0                  | 25                            | 2.20                 |
| SSB06032R2MZF | 2.2 $\pm$ 20%            | 35        | 1V / 100K                   | 100.0                  | 32                            | 1.90                 |
| SSB06033R3MZF | 3.3 $\pm$ 20%            | 35        | 1V / 100K                   | 85.0                   | 50                            | 1.50                 |
| SSB06034R7MZF | 4.7 $\pm$ 20%            | 35        | 1V / 100K                   | 65.0                   | 60                            | 1.30                 |
| SSB06036R8MZF | 6.8 $\pm$ 20%            | 35        | 1V / 100K                   | 55.0                   | 70                            | 1.20                 |
| SSB0603100MZF | 10.0 $\pm$ 20%           | 40        | 1V / 100K                   | 45.0                   | 120                           | 1.00                 |
| SSB0603120MZF | 12.0 $\pm$ 20%           | 40        | 1V / 100K                   | 40.0                   | 130                           | 0.90                 |
| SSB0603150MZF | 15.0 $\pm$ 20%           | 35        | 1V / 100K                   | 38.0                   | 150                           | 0.80                 |
| SSB0603180MZF | 18.0 $\pm$ 20%           | 35        | 1V / 100K                   | 35.0                   | 160                           | 0.75                 |
| SSB0603220MZF | 22.0 $\pm$ 20%           | 40        | 1V / 100K                   | 26.0                   | 230                           | 0.65                 |
| SSB0603270MZF | 27.0 $\pm$ 20%           | 40        | 1V / 100K                   | 24.0                   | 250                           | 0.60                 |
| SSB0603330MZF | 33.0 $\pm$ 20%           | 45        | 1V / 100K                   | 22.0                   | 340                           | 0.55                 |
| SSB0603390MZF | 39.0 $\pm$ 20%           | 45        | 1V / 100K                   | 20.0                   | 380                           | 0.52                 |
| SSB0603470MZF | 47.0 $\pm$ 20%           | 45        | 1V / 100K                   | 19.0                   | 420                           | 0.50                 |
| SSB0603560MZF | 56.0 $\pm$ 20%           | 45        | 1V / 100K                   | 17.0                   | 570                           | 0.48                 |
| SSB0603680MZF | 68.0 $\pm$ 20%           | 50        | 1V / 100K                   | 14.0                   | 620                           | 0.45                 |
| SSB0603820MZF | 82.0 $\pm$ 20%           | 50        | 1V / 100K                   | 13.0                   | 900                           | 0.40                 |
| SSB0603101MZF | 100.0 $\pm$ 20%          | 50        | 1V / 100K                   | 12.0                   | 990                           | 0.35                 |
| SSB0603121MZF | 120.0 $\pm$ 20%          | 50        | 1V / 100K                   | 11.0                   | 1150                          | 0.30                 |
| SSB0603151MZF | 150.0 $\pm$ 20%          | 50        | 1V / 100K                   | 9.0                    | 1750                          | 0.28                 |
| SSB0603181MZF | 180.0 $\pm$ 20%          | 55        | 1V / 100K                   | 8.0                    | 1950                          | 0.26                 |
| SSB0603221MZF | 220.0 $\pm$ 20%          | 55        | 1V / 100K                   | 7.5                    | 2200                          | 0.22                 |
| SSB0603271MZF | 270.0 $\pm$ 20%          | 55        | 1V / 100K                   | 7.0                    | 2500                          | 0.20                 |
| SSB0603331MZF | 330.0 $\pm$ 20%          | 55        | 1V / 100K                   | 6.0                    | 3200                          | 0.18                 |
| SSB0603391MZF | 390.0 $\pm$ 20%          | 55        | 1V / 100K                   | 5.5                    | 3500                          | 0.17                 |
| SSB0603471MZF | 470.0 $\pm$ 20%          | 55        | 1V / 100K                   | 5.0                    | 4950                          | 0.16                 |
| SSB0603561MZF | 560.0 $\pm$ 20%          | 55        | 1V / 100K                   | 4.8                    | 5350                          | 0.15                 |
| SSB0603681MZF | 680.0 $\pm$ 20%          | 55        | 1V / 100K                   | 4.5                    | 6300                          | 0.14                 |
| SSB0603821MZF | 820.0 $\pm$ 20%          | 55        | 1V / 100K                   | 4.0                    | 8200                          | 0.13                 |
| SSB0603102MZF | 1000.0 $\pm$ 20%         | 55        | 1V / 100K                   | 3.5                    | 9200                          | 0.12                 |



RoHS Compliant

NOTE : Specifications subject to change without notice. Please check our website for latest information.

22.12.2014



SUPERWORLD ELECTRONICS (S) PTE LTD

PG. 2

## 7. CHARACTERISTICS CURVES :

@ TEMP. RISE VS. DC SUPERPOSITION RESPONSE CURVE

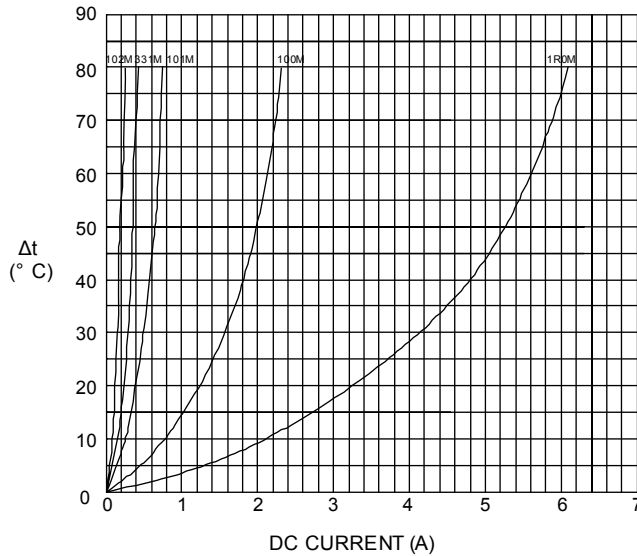

@ INDUCTANCE VS. FREQUENCY RESPONSE CURVE

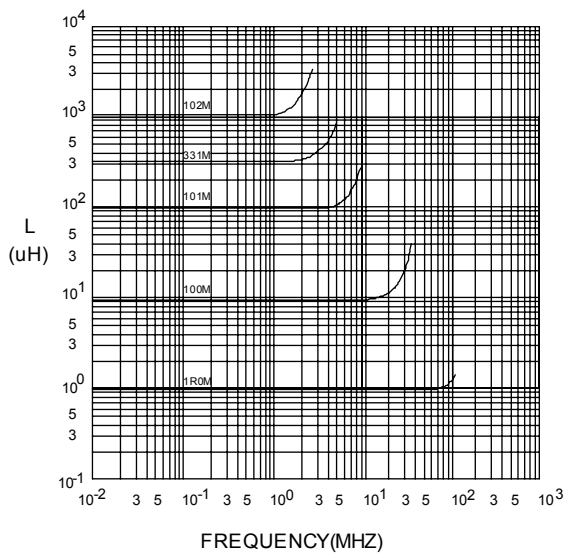

@ INDUCTANCE VS. DC SUPERPOSITION RESPONSE CURVE

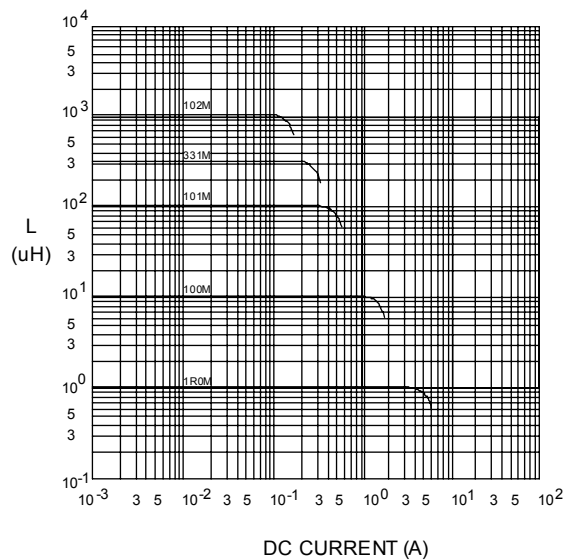

NOTE : Specifications subject to change without notice. Please check our website for latest information.



**RoHS Compliant**



### RECOMMENDED SOLDERING CONDITIONS REFLOW SOLDERINGS

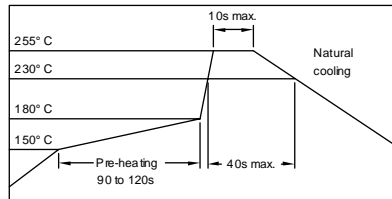

### 8. PACKAGING INFORMATION :

#### ( 1 ) CONFIGURATION

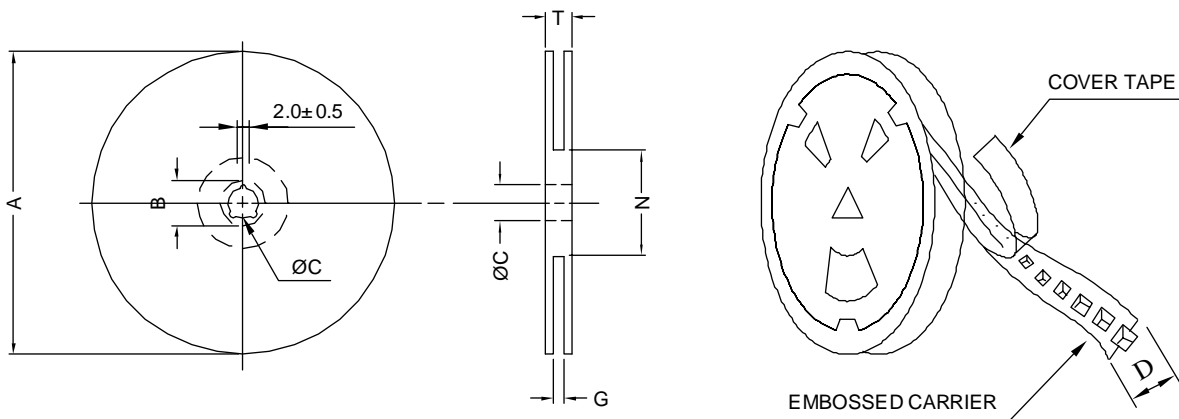

\* CARRIER TAPE WIDTH : D

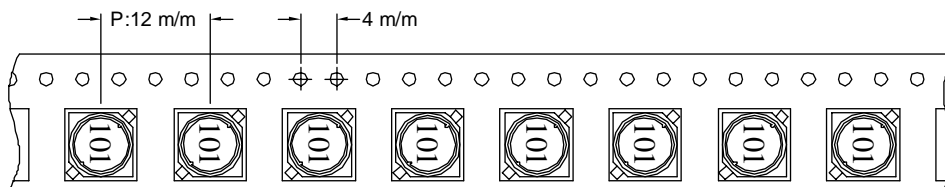

#### ( 2 ) DIMENSIONS

Unit:m/m

| STYLE | A   | B      | C  | D  | G                | N                | T    |
|-------|-----|--------|----|----|------------------|------------------|------|
| 13-16 | 330 | 21±0.8 | 13 | 16 | 18 <sup>+0</sup> | 50 <sup>-0</sup> | 22.4 |

#### ( 3 ) QTY & G.W. PER PACKAGE

| SERIES  | INNER : REEL |           |       | OUTER : CARTON |           |              |
|---------|--------------|-----------|-------|----------------|-----------|--------------|
|         | QTY (PCS)    | G.W. (gw) | STYLE | QTY (PCS)      | G.W. (Kg) | SIZE (cm)    |
| SSB0603 | 1000         | 800       | 13-16 | 6000           | 8.3       | 40 x 40 x 24 |



**RoHS Compliant**

NOTE : Specifications subject to change without notice. Please check our website for latest information.

22.12.2014



**SUPERWORLD ELECTRONICS (S) PTE LTD**