

### 1. PART NO. EXPRESSION :

SDB1105101MZ F  
 (a) (b) (c) (d)(e)(f)

- (a) Series code
- (b) Dimension code
- (c) Inductance code : 101 = 100uH
- (d) Tolerance code : M = ±20%
- (e) Z : Standard part
- (f) F : RoHS Compliant

### 2. CONFIGURATION & DIMENSIONS :

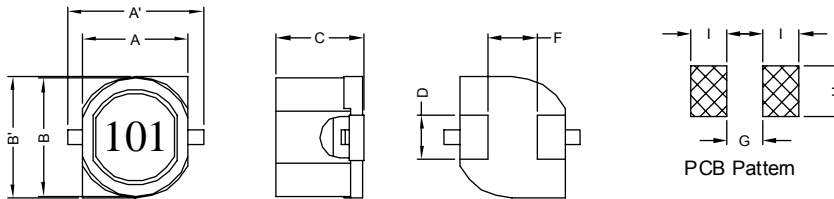

Unit: m/m

A'	A	B'	B	C	D	F	G	H	I
15.0 Max.	11.6 Ref.	12.7±0.3	12.6 Ref.	5.7±0.3	3.0±0.2	8.2±0.3	7.3 Ref.	3.9 Ref.	2.8 Ref.

### 3. SCHEMATIC :



### 4. MATERIALS :

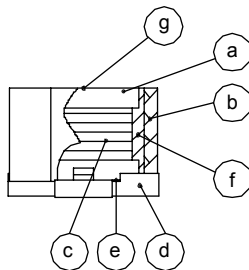

- (a) DR Core
- (b) RI Core
- (c) Wire
- (d) Base
- (e) Terminal
- (f) Adhesive
- (g) Ink

### 5. GENERAL SPECIFICATION :

- a) Temp. rise : 50° C Max. at Rated Current.
- b) Rated current : Base on temp. rise  $\Delta L/L0A = 10\%$  Typ.
- c) Operating temp. : -40° C to +75° C
- d) Storage condition (component in its packaging)
  - i) Temperature : -10 to 40° C
  - ii) Humidity : 60%
- e) Resistance to solder heat : 260° C.10 secs



**RoHS Compliant**

NOTE : Specifications subject to change without notice. Please check our website for latest information.

25.11.2014



**SUPERWORLD ELECTRONICS (S) PTE LTD**

## 6. ELECTRICAL CHARACTERISTICS :

Part No.	Inductance ( $\mu$ H)	Test Freq. ( Hz )	RDC ( $\Omega$ ) Max.	IDC ( A )
SDB1105100MZF	10 $\pm$ 20%	1V/1K	0.05	2.50
SDB1105120MZF	12 $\pm$ 20%	1V/1K	0.05	2.40
SDB1105150MZF	15 $\pm$ 20%	1V/1K	0.06	2.30
SDB1105180MZF	18 $\pm$ 20%	1V/1K	0.07	2.20
SDB1105220MZF	22 $\pm$ 20%	1V/1K	0.08	2.10
SDB1105270MZF	27 $\pm$ 20%	1V/1K	0.10	2.00
SDB1105330MZF	33 $\pm$ 20%	1V/1K	0.10	1.90
SDB1105390MZF	39 $\pm$ 20%	1V/1K	0.12	1.80
SDB1105470MZF	47 $\pm$ 20%	1V/1K	0.14	1.60
SDB1105560MZF	56 $\pm$ 20%	1V/1K	0.15	1.40
SDB1105680MZF	68 $\pm$ 20%	1V/1K	0.18	1.30
SDB1105820MZF	82 $\pm$ 20%	1V/1K	0.20	1.20
SDB1105101MZF	100 $\pm$ 20%	1V/1K	0.25	1.10
SDB1105121MZF	120 $\pm$ 20%	1V/1K	0.30	0.97
SDB1105151MZF	150 $\pm$ 20%	1V/1K	0.35	0.86
SDB1105181MZF	180 $\pm$ 20%	1V/1K	0.40	0.84
SDB1105221MZF	220 $\pm$ 20%	1V/1K	0.50	0.72
SDB1105271MZF	270 $\pm$ 20%	1V/1K	0.60	0.65
SDB1105331MZF	330 $\pm$ 20%	1V/1K	0.70	0.61
SDB1105391MZF	390 $\pm$ 20%	1V/1K	0.80	0.58
SDB1105471MZF	470 $\pm$ 20%	1V/1K	0.90	0.50
SDB1105561MZF	560 $\pm$ 20%	1V/1K	1.10	0.48
SDB1105681MZF	680 $\pm$ 20%	1V/1K	1.20	0.43
SDB1105821MZF	820 $\pm$ 20%	1V/1K	1.50	0.38
SDB1105102MZF	1000 $\pm$ 20%	1V/1K	2.00	0.35
SDB1105122MZF	1200 $\pm$ 20%	1V/1K	2.20	0.32
SDB1105152MZF	1500 $\pm$ 20%	1V/1K	2.50	0.30



RoHS Compliant

NOTE : Specifications subject to change without notice. Please check our website for latest information.

25.11.2014



SUPERWORLD ELECTRONICS (S) PTE LTD

PG. 2

## 6. ELECTRICAL CHARACTERISTICS :

@ TEMP. RISE VS. DC SUPERPOSITION RESPONSE CURVE

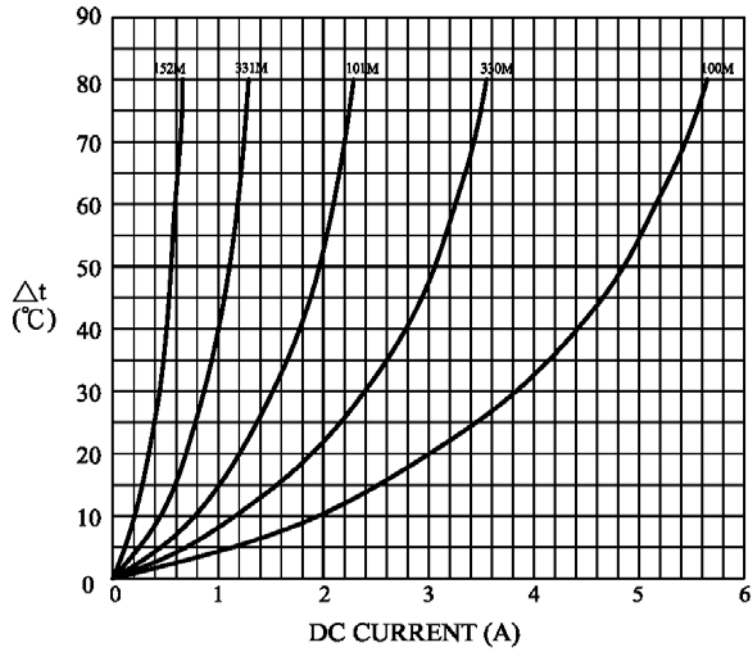

@ INDUCTANCE VS. FREQUENCY RESPONSE CURVE

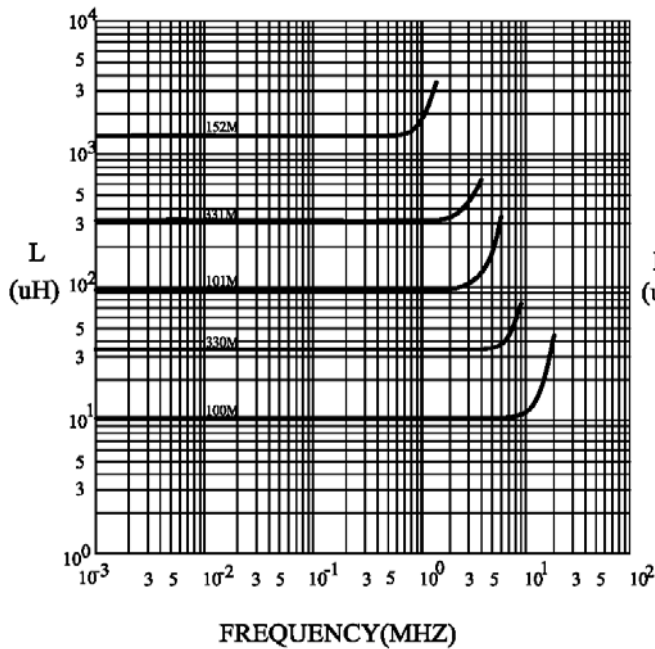

@ INDUCTANCE VS. DC SUPERPOSITION RESPONSE CURVE

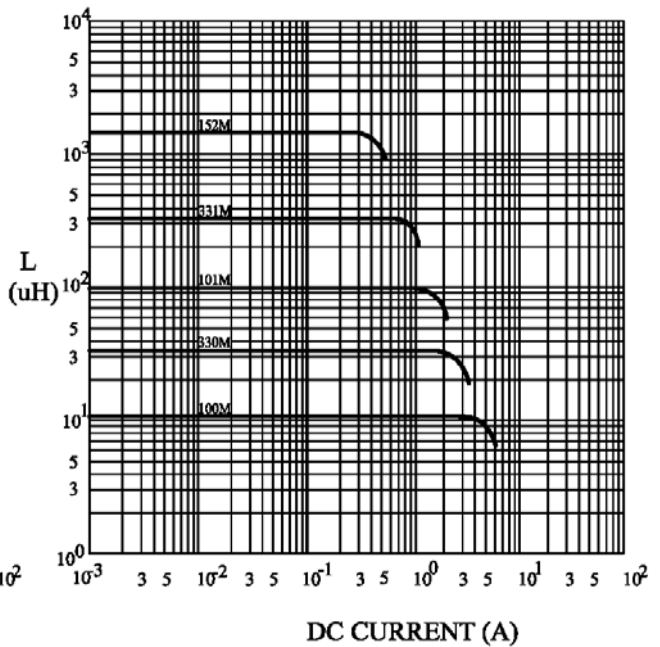

**RoHS Compliant**

NOTE : Specifications subject to change without notice. Please check our website for latest information.



### RECOMMENDED SOLDERING CONDITIONS REFLOW SOLDERINGS

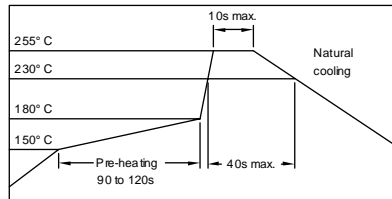

### 7. PACKAGING INFORMATION :

#### ( 1 ) CONFIGURATION

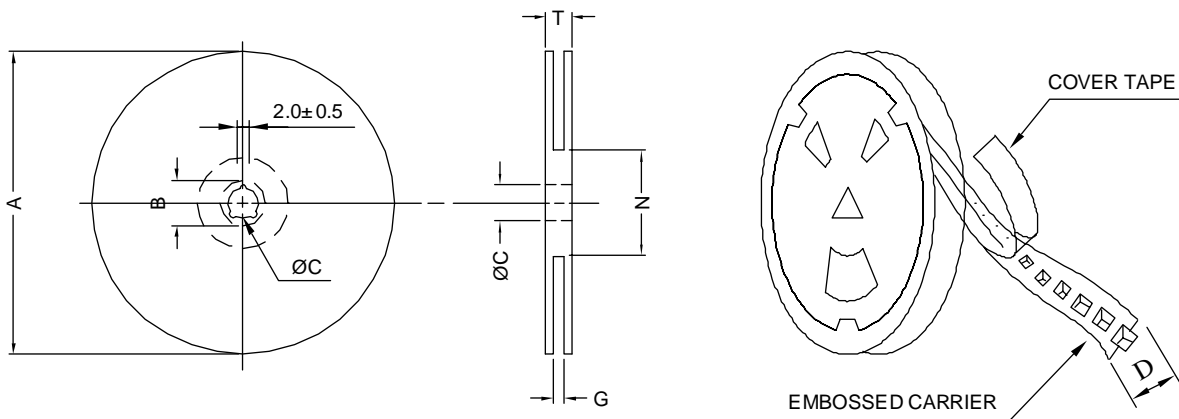

\* CARRIER TAPE WIDTH : D

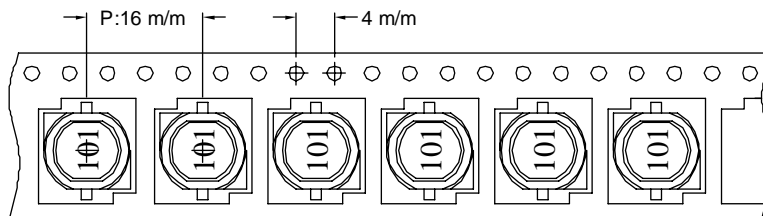

#### ( 2 ) DIMENSIONS

Unit:m/m

STYLE	A	B	C	D	G	N	T
13-24	330	21±0.8	13	24	26 <sup>+0</sup>	50 <sup>-0</sup>	30.4

#### ( 3 ) QTY & G.W. PER PACKAGE

SERIES	INNER : REEL			OUTER : CARTON		
	QTY (PCS)	G.W. (gw)	STYLE	QTY (PCS)	G.W. (Kg)	SIZE (cm)
SDB1105	500	1500	13-24	2000	9.5	40 x 40 x 24



**RoHS Compliant**

NOTE : Specifications subject to change without notice. Please check our website for latest information.

25.11.2014



**SUPERWORLD ELECTRONICS (S) PTE LTD**