

1. PART NO. EXPRESSION :

SDB1005101MZ F
 (a) (b) (c) (d)(e)(f)

- (a) Series code
- (b) Dimension code
- (c) Inductance code : 101 = 100uH
- (d) Tolerance code : M = ±20%
- (e) Z : Standard part
- (f) F : RoHS Compliant

2. CONFIGURATION & DIMENSIONS :

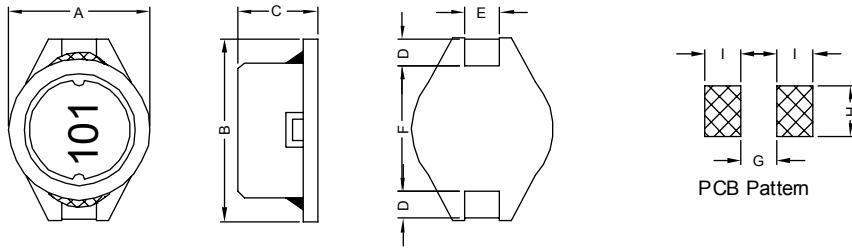

Unit: m/m

A	B	C	D	E	F	G	H	I
10.0± 0.20	12.7± 0.20	4.90± 0.30	2.40± 0.20	2.20± 0.20	7.60± 0.30	7.30 Ref.	2.80 Ref.	3.00 Ref.

3. SCHEMATIC :

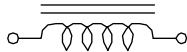

4. MATERIALS :

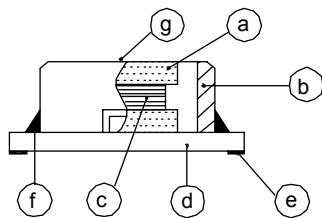

- (a) DR Core
- (b) RI Core
- (c) Wire
- (d) Base
- (e) Terminal
- (f) Adhesive
- (g) Ink

5. GENERAL SPECIFICATION :

- a) Temp. rise : 40° C Max. at Rated Current.
- b) Rated current : Base on temp. rise $\Delta L/L0A = 10\%$ Max.
- c) Operating temp. : -40° C to +85° C
- d) Storage condition (component in its packaging)
 - i) Temperature : -10 to 40° C
 - ii) Humidity : 60%
- e) Resistance to solder heat : 260° C.10 secs



RoHS Compliant

NOTE : Specifications subject to change without notice. Please check our website for latest information.

25.11.2014

6. ELECTRICAL CHARACTERISTICS :

Part No.	Inductance (μ H)	Q Ref.	Test Freq. (Hz)	SRF (MHz) Typ.	RDC (m Ω) Max.	IDC (A)
SDB10051R0MZ	1.0 \pm 20%	50	1V/100K	130.0	21	5.00
SDB10051R5MZ	1.5 \pm 20%	60	1V/100K	110.0	22	4.50
SDB10052R2MZ	2.2 \pm 20%	70	1V/100K	90.0	27	3.10
SDB10053R0MZ	3.0 \pm 20%	70	1V/100K	65.0	30	2.90
SDB10054R7MZ	4.7 \pm 20%	70	1V/100K	50.0	40	2.50
SDB10056R8MZ	6.8 \pm 20%	70	1V/100K	30.0	55	2.20
SDB1005100MZ	10.0 \pm 20%	60	1V/100K	28.0	65	2.00
SDB1005120MZ	12.0 \pm 20%	60	1V/100K	25.0	80	1.80
SDB1005150MZ	15.0 \pm 20%	60	1V/100K	20.0	85	1.70
SDB1005180LZ	18.0 \pm 15%	60	1V/100K	19.0	90	1.60
SDB1005220LZ	22.0 \pm 15%	50	1V/100K	18.0	100	1.40
SDB1005270LZ	27.0 \pm 15%	50	1V/100K	16.0	120	1.30
SDB1005330LZ	33.0 \pm 15%	70	1V/100K	14.0	160	1.20
SDB1005390LZ	39.0 \pm 15%	70	1V/100K	12.0	180	1.05
SDB1005470LZ	47.0 \pm 15%	70	1V/100K	11.0	190	1.00
SDB1005560LZ	56.0 \pm 15%	70	1V/100K	10.0	210	0.90
SDB1005680LZ	68.0 \pm 15%	85	1V/100K	9.0	340	0.82
SDB1005820LZ	82.0 \pm 15%	85	1V/100K	8.0	380	0.75
SDB1005101KZ	100.0 \pm 10%	85	1V/100K	7.5	420	0.68
SDB1005121KZ	120.0 \pm 10%	90	1V/100K	7.0	460	0.60
SDB1005151KZ	150.0 \pm 10%	90	1V/100K	6.3	520	0.55
SDB1005181KZ	180.0 \pm 10%	100	1V/100K	5.5	700	0.50
SDB1005221KZ	220.0 \pm 10%	100	1V/100K	5.0	800	0.45
SDB1005271KZ	270.0 \pm 10%	100	1V/100K	4.5	1100	0.40
SDB1005331KZ	330.0 \pm 10%	110	1V/100K	4.0	1200	0.35
SDB1005391KZ	390.0 \pm 10%	110	1V/100K	3.8	1400	0.33



RoHS Compliant

NOTE : Specifications subject to change without notice. Please check our website for latest information.

25.11.2014



SUPERWORLD ELECTRONICS (S) PTE LTD

PG. 2

Part No.	Inductance (μ H)	Q Ref.	Test Freq. (Hz)	SRF (MHz) Typ.	RDC (m Ω) Max.	IDC (A)
SDB1005471KZF	470.0 \pm 10%	70	1V/100K	3.0	1600	0.30
SDB1005561KZF	560.0 \pm 10%	70	1V/100K	2.7	1800	0.28
SDB1005681KZF	680.0 \pm 10%	70	1V/100K	2.6	2300	0.26
SDB1005821KZF	820.0 \pm 10%	70	1V/100K	2.5	2600	0.24
SDB1005102KZF	1000.0 \pm 10%	70	1V/100K	2.0	3200	0.22
SDB1005122KZF	1200.0 \pm 10%	70	1V/100K	2.0	3600	0.20
SDB1005152KZF	1500.0 \pm 10%	70	1V/100K	1.6	5200	0.17
SDB1005182KZF	1800.0 \pm 10%	70	1V/100K	1.4	5700	0.16
SDB1005222KZF	2200.0 \pm 10%	70	1V/100K	1.4	6500	0.14
SDB1005272KZF	2700.0 \pm 10%	70	1V/100K	1.2	8600	0.12
SDB1005332KZF	3300.0 \pm 10%	70	1V/100K	1.2	10000	0.10



RoHS Compliant

NOTE : Specifications subject to change without notice. Please check our website for latest information.

25.11.2014



SUPERWORLD ELECTRONICS (S) PTE LTD

7. ELECTRICAL CHARACTERISTICS :

@ TEMP. RISE VS. DC SUPERPOSITION RESPONSE CURVE

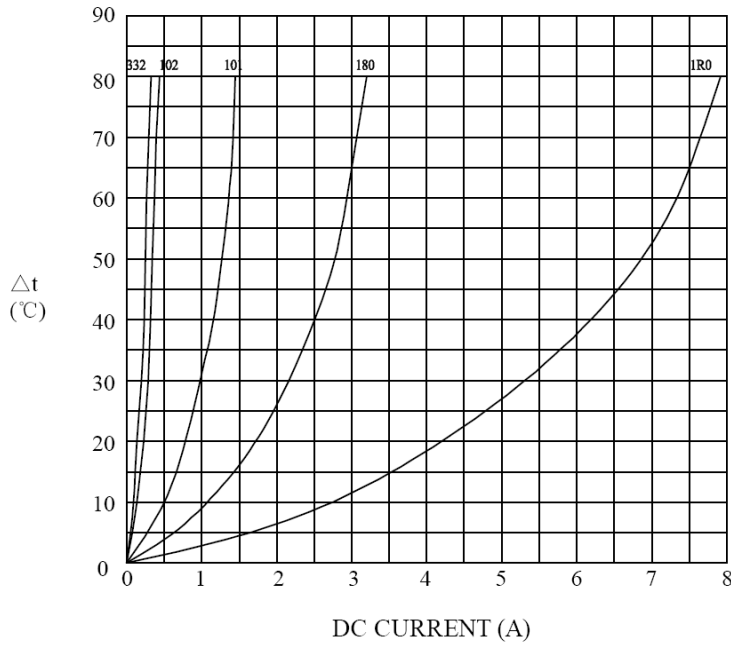

@ INDUCTANCE VS. FREQUENCY RESPONSE CURVE

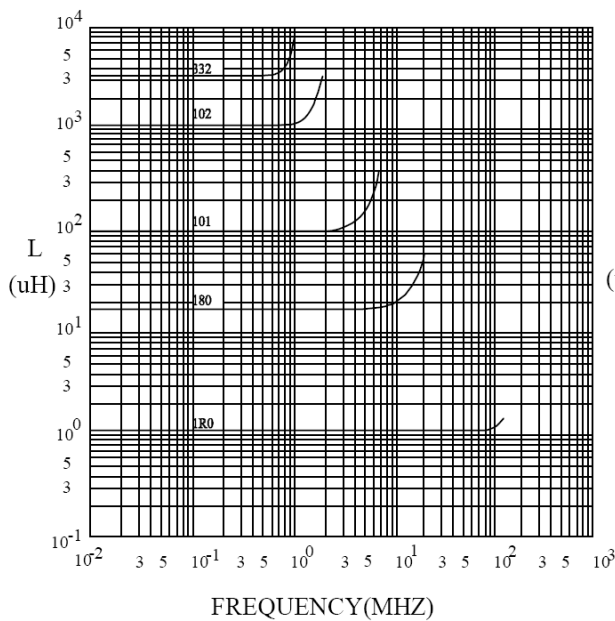

@ INDUCTANCE VS. DC SUPERPOSITION RESPONSE CURVE

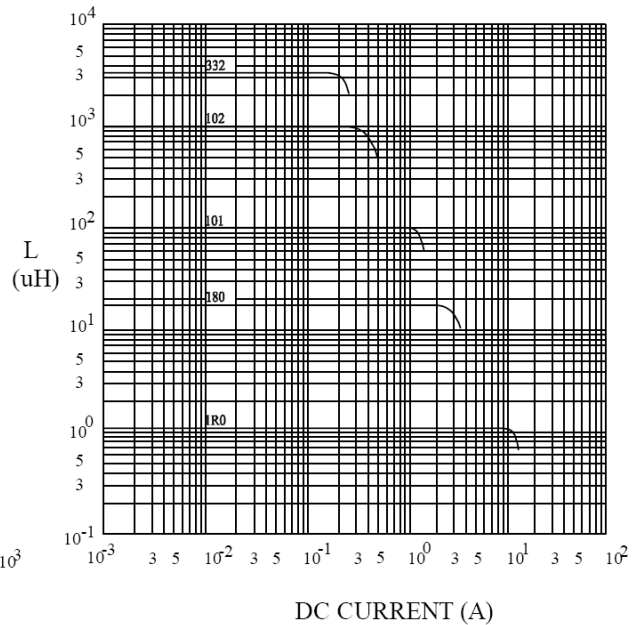

NOTE : Specifications subject to change without notice. Please check our website for latest information.



RoHS Compliant

25.11.2014



SUPERWORLD ELECTRONICS (S) PTE LTD

RECOMMENDED SOLDERING CONDITIONS REFLOW SOLDERINGS

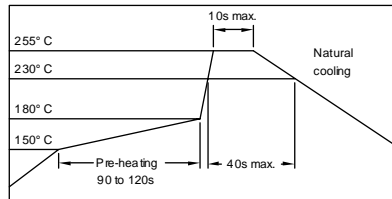

8. PACKAGING INFORMATION :

(1) CONFIGURATION

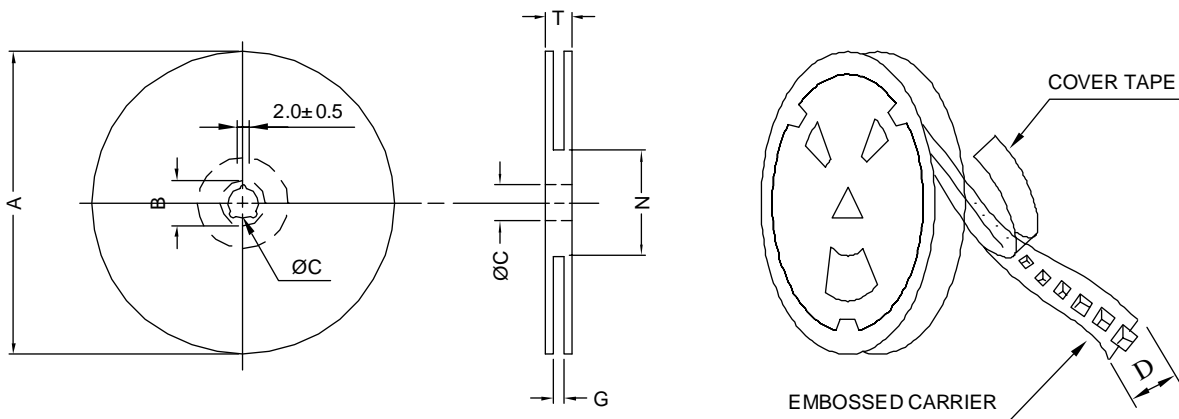

* CARRIER TAPE WIDTH : D

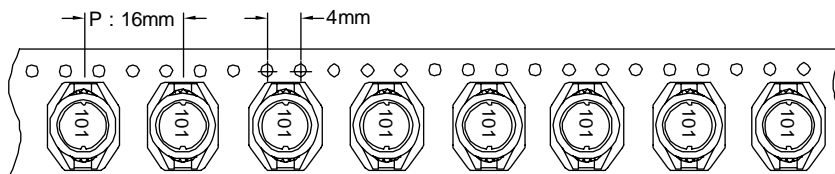

(2) DIMENSIONS

Unit:m/m

STYLE	A	B	C	D	G	N	T
13-24	330	21±0.8	13	24	26 ⁺⁰	50 ⁻⁰	30.4

(3) QTY & G.W. PER PACKAGE

SERIES	INNER : REEL			OUTER : CARTON		
	QTY (PCS)	G.W. (gw)	STYLE	QTY (PCS)	G.W. (Kg)	SIZE (cm)
SDB1005	600	1100	13-24	2400	7.9	38 x 36.5 x 21
SDB1005	500	916	13-24	2000	6.6	38 x 36.5 x 21



RoHS Compliant

NOTE : Specifications subject to change without notice. Please check our website for latest information.

