

1. PART NO. EXPRESSION :

SDB 1003 101 MZF
 (a) (b) (c) (d)(e)(f)

- (a) Series code
- (b) Dimension code
- (c) Inductance code : 101 = 100uH
- (d) Tolerance code : M = ±20%
- (e) Z : Standard part
- (f) F : RoHS Compliant

2. CONFIGURATION & DIMENSIONS :

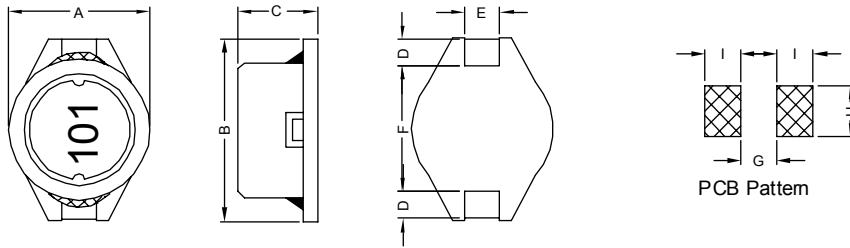

Unit: m/m

A	B	C	D	E	F	G	H	I
10.1± 0.20	12.7± 0.20	2.70± 0.30	2.40± 0.20	2.20± 0.20	7.60± 0.30	7.30 Ref.	2.80 Ref.	3.00 Ref.

3. SCHEMATIC :



4. MATERIALS :

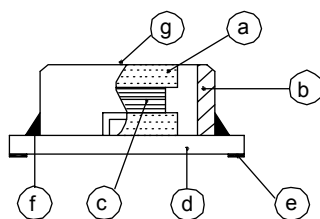

- (a) DR Core
- (b) RI Core
- (c) Wire
- (d) Base
- (e) Terminal
- (f) Adhesive
- (g) Ink

5. GENERAL SPECIFICATION :

- a) Temp. rise : 40° C Max. at Rated Current.
- b) Rated current : Base on temp. rise $\Delta L/L0A = 10\%$ Max.
- c) Operating temp. : -40° C to +125° C
- d) Storage condition (component in its packaging)
 - i) Temperature : -10 to 40° C
 - ii) Humidity : 60%
- e) Resistance to solder heat : 260° C.10 secs



RoHS Compliant

NOTE : Specifications subject to change without notice. Please check our website for latest information.

25.11.2014

6. ELECTRICAL CHARACTERISTICS :

Part No.	Inductance (uH)	Q Ref.	Test Freq. (Hz)	SRF (MHz) Typ.	RDC (mΩ) Max.	IDC (A)
SDB10032R2MZF	2.2± 20%	30	1V/100K	90.0	45	3.50
SDB10033R0MZF	3.0± 20%	30	1V/100K	70.0	62	3.00
SDB10033R9MZF	3.9± 20%	30	1V/100K	60.0	70	2.80
SDB10034R7MZF	4.7± 20%	30	1V/100K	50.0	78	2.50
SDB10036R8MZF	6.8± 20%	30	1V/100K	50.0	100	2.20
SDB1003100MZF	10.0± 20%	30	1V/100K	38.0	145	2.00
SDB1003120MZF	12.0± 20%	35	1V/100K	29.0	185	1.75
SDB1003150MZF	15.0± 20%	35	1V/100K	30.0	200	1.50
SDB1003180MZF	18.0± 20%	35	1V/100K	25.0	270	1.40
SDB1003220MZF	22.0± 20%	40	1V/100K	22.0	300	1.30
SDB1003270MZF	27.0± 20%	40	1V/100K	18.0	400	1.20
SDB1003330MZF	33.0± 20%	40	1V/100K	17.0	450	1.10
SDB1003390MZF	39.0± 20%	40	1V/100K	17.0	560	0.95
SDB1003470MZF	47.0± 20%	40	1V/100K	15.0	650	0.80
SDB1003560MZF	56.0± 20%	40	1V/100K	14.0	680	0.75
SDB1003680MZF	68.0± 20%	40	1V/100K	12.0	800	0.70
SDB1003820MZF	82.0± 20%	30	1V/100K	11.0	1200	0.65
SDB1003101MZF	100.0± 20%	45	1V/100K	9.5	1400	0.60
SDB1003121MZF	120.0± 20%	50	1V/100K	8.5	1520	0.55
SDB1003151MZF	150.0± 20%	50	1V/100K	8.0	1800	0.50
SDB1003181MZF	180.0± 20%	50	1V/100K	7.0	2200	0.45
SDB1003221MZF	220.0± 20%	50	1V/100K	6.5	2200	0.40
SDB1003271LZF	270.0± 15%	50	1V/100K	5.5	3100	0.35
SDB1003331LZF	330.0± 15%	45	1V/100K	5.2	3600	0.30
SDB1003391LZF	390.0± 15%	45	1V/100K	5.0	4600	0.25
SDB1003471LZF	470.0± 15%	50	1V/100K	4.5	5100	0.20



RoHS Compliant

NOTE : Specifications subject to change without notice. Please check our website for latest information.

25.11.2014



SUPERWORLD ELECTRONICS (S) PTE LTD

PG. 2

6. ELECTRICAL CHARACTERISTICS :

@ TEMP. RISE VS. DC SUPERPOSITION RESPONSE CURVE

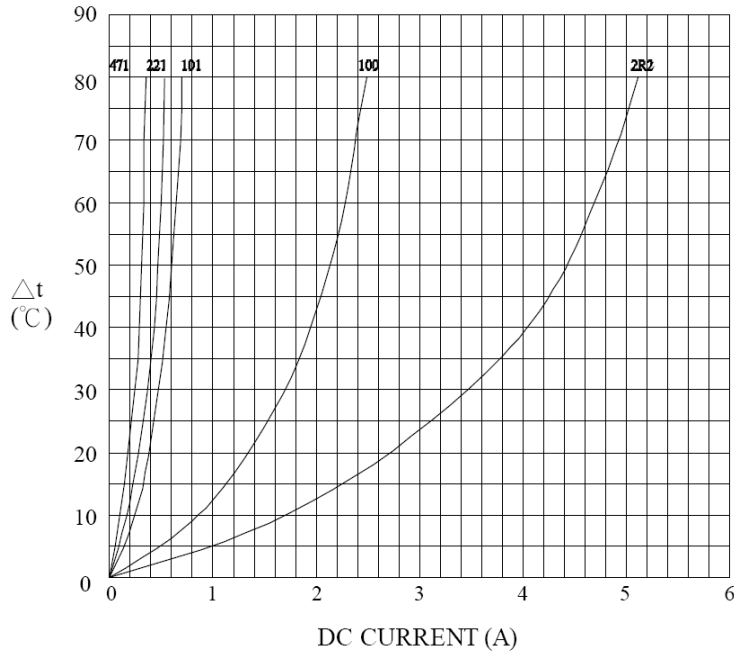

@ INDUCTANCE VS. FREQUENCY RESPONSE CURVE

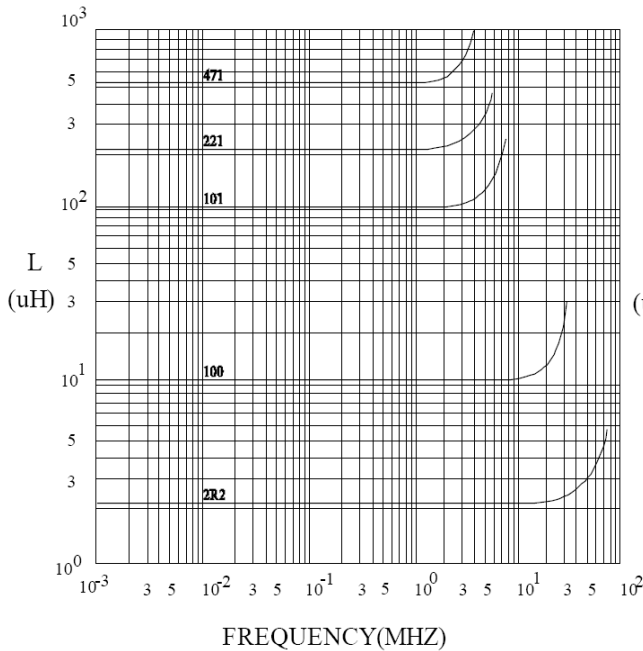

@ INDUCTANCE VS. DC SUPERPOSITION RESPONSE CURVE

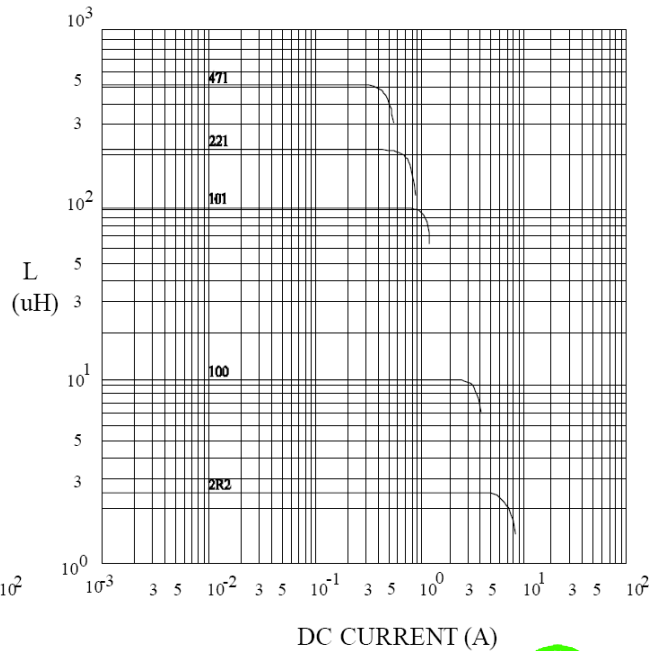

NOTE : Specifications subject to change without notice. Please check our website for latest information.



RoHS Compliant

25.11.2014



RECOMMENDED SOLDERING CONDITIONS REFLOW SOLDERINGS

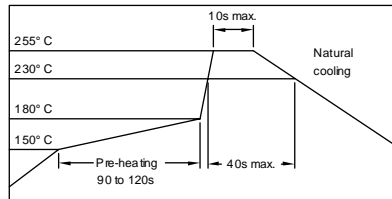

7. PACKAGING INFORMATION :

(1) CONFIGURATION

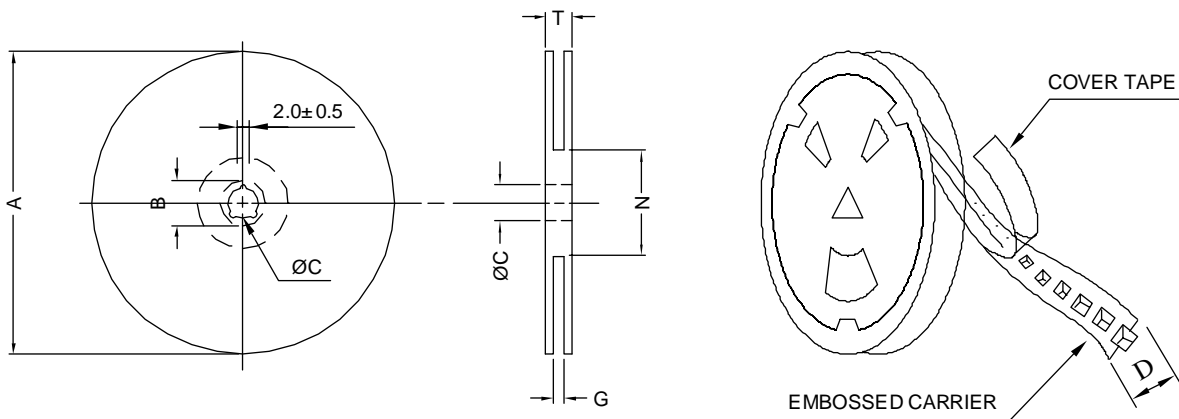

* CARRIER TAPE WIDTH : D

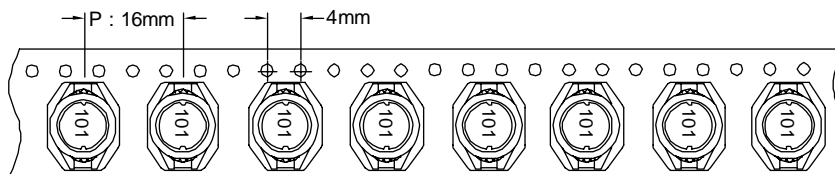

(2) DIMENSIONS

Unit:m/m

STYLE	A	B	C	D	G	N	T
13-24	330	21±0.8	13	24	26 ⁺⁰	50 ⁻⁰	30.4

(3) QTY & G.W. PER PACKAGE

SERIES	INNER : REEL			OUTER : CARTON		
	QTY (PCS)	G.W. (gw)	STYLE	QTY (PCS)	G.W. (Kg)	SIZE (cm)
SDB1003	1000	1000	13-24	4000	7.5	40 x 40 x 24



RoHS Compliant

NOTE : Specifications subject to change without notice. Please check our website for latest information.

25.11.2014



SUPERWORLD ELECTRONICS (S) PTE LTD