

1. Part No. Expression:

SCR20015R0K

(a) (b) (c) (d)

- a) Series code c) Inductance Code
 b) Dimension code d) Tolerance Code

2. Configuration & Dimensions: (Unit-mm)

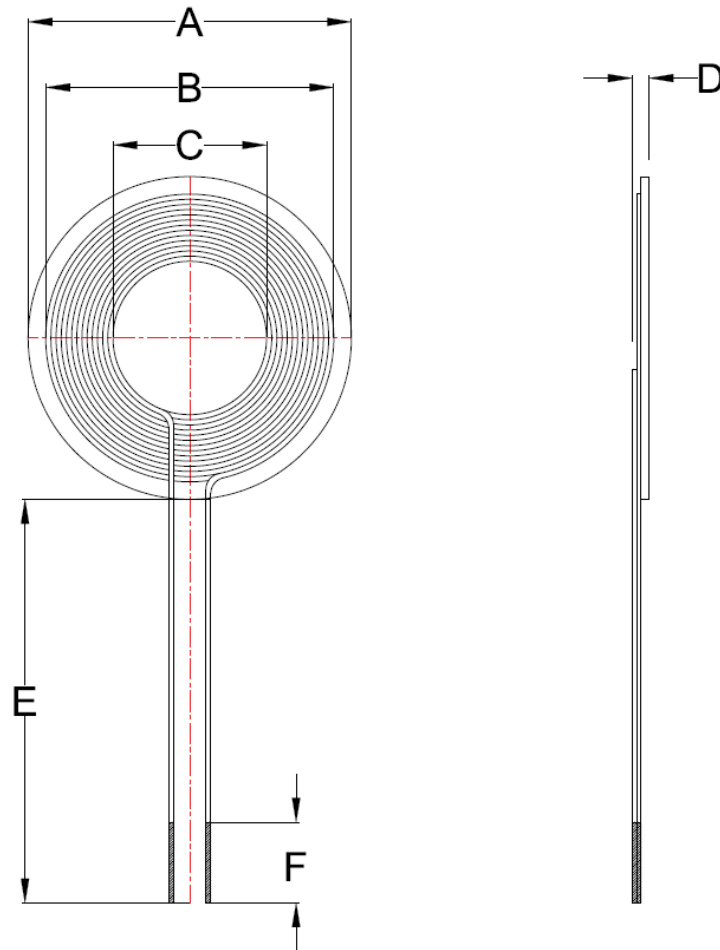

A	B	C	D	E	F
20.0±0.5	17.5 Ref	9.5±0.5	1.5 Max	25.0±2.0	5.0±2.0

NOTE: Specifications subject to change without notice. Please check our website for latest information.



3. Schematic:



4. Electrical Characteristics:

Inductance (uH)	Test Frequency (Hz)	DCR (mΩ)	Irms (mA)
5.0±10%	1V/100K	180 Max	1200 Max

5. General Specifications:

- a) Operating Temp.: -40°C ~ +85°C
- b) Storage Temp.: -40°C ~ +85°C (packaging)
- c) Irms: Based on temp. rise up to 40°C Max.
- d) Power Rating: 3.5W

6. Material List:

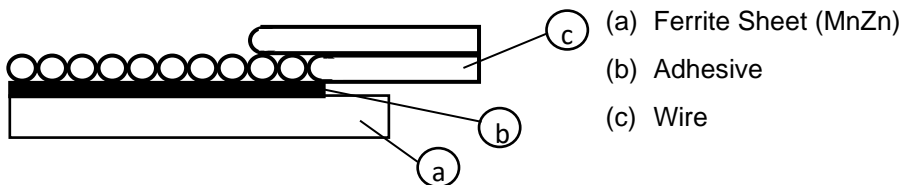

NOTE: Specifications subject to change without notice. Please check our website for latest information.