

### 1. PART NO. EXPRESSION :

PSB0605 1R2 MZF  
 (a) (b) (c) (d)(e)(f)

(a) Series code

(b) Dimension code

(c) Inductance code : 1R2 = 1.2uH

(d) Tolerance code : K = ± 10%, M = ± 20%

(e) Z : Standard part

(f) F : RoHS Compliant

### 2. CONFIGURATION & DIMENSIONS :

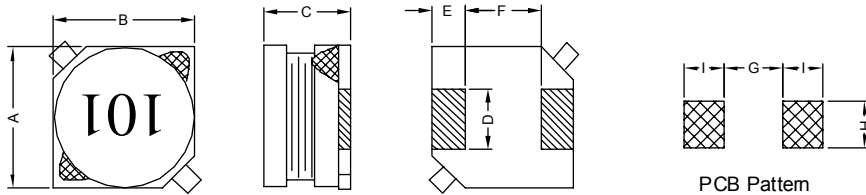

Unit:m/m

A	B	C	D	E	F	G	H	I
6.0±0.3	6.0±0.3	4.9±0.3	2.0±0.2	1.5±0.2	3.0±0.2	2.8 Ref.	2.2 Ref.	1.9 Ref.

### 3. SCHEMATIC :



### 4. MATERIALS :

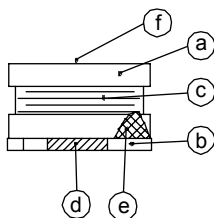

(a) Core

(b) Base

(c) Wire

(d) Terminal

(e) Adhesive

(f) Ink

### 5. GENERAL SPECIFICATION :

- a) Temp. rise : 40° C Max. at Rated Current.
- b) Rated current : Base on temp. rise &  $\Delta L/L0A = 10\%$  Max.
- c) Operating temp. : -40° C to +85° C
- d) Storage condition (component in its packaging)
  - i) Temperature : -10 to 40° C
  - ii) Humidity : 60%
- e) Resistance to solder heat : 260° C.10 secs



**RoHS Compliant**

NOTE : Specifications subject to change without notice. Please check our website for latest information.



### 6. ELECTRICAL CHARACTERISTICS :

Part No.	Inductance ( $\mu$ H)	Test Frequency ( Hz )	RDC ( m $\Omega$ ) Max.	IDC ( A ) Max.
PSB06051R2MZF	1.2 $\pm$ 20%	1V / 100K	28	3.50
PSB06051R5MZF	1.5 $\pm$ 20%	1V / 100K	30	3.00
PSB06052R2MZF	2.2 $\pm$ 20%	1V / 100K	35	2.70
PSB06053R3MZF	3.3 $\pm$ 20%	1V / 100K	42	2.50
PSB06054R7MZF	4.7 $\pm$ 20%	1V / 100K	50	2.20
PSB06056R8MZF	6.8 $\pm$ 20%	1V / 100K	60	2.00
PSB0605100MZF	10.0 $\pm$ 20%	1V / 100K	70	1.80
PSB0605120MZF	12.0 $\pm$ 20%	1V / 100K	80	1.60
PSB0605150MZF	15.0 $\pm$ 20%	1V / 100K	90	1.50
PSB0605180MZF	18.0 $\pm$ 20%	1V / 100K	95	1.30
PSB0605220MZF	22.0 $\pm$ 20%	1V / 100K	110	1.20
PSB0605270MZF	27.0 $\pm$ 20%	1V / 100K	130	1.10
PSB0605330KZF	33.0 $\pm$ 10%	1V / 100K	180	1.00
PSB0605390KZF	39.0 $\pm$ 10%	1V / 100K	210	0.90
PSB0605470KZF	47.0 $\pm$ 10%	1V / 100K	220	0.80
PSB0605560KZF	56.0 $\pm$ 10%	1V / 100K	250	0.75
PSB0605680KZF	68.0 $\pm$ 10%	1V / 100K	300	0.70
PSB0605820KZF	82.0 $\pm$ 10%	1V / 100K	390	0.60
PSB0605101KZF	100.0 $\pm$ 10%	1V / 100K	430	0.55
PSB0605121KZF	120.0 $\pm$ 10%	1V / 100K	500	0.50
PSB0605151KZF	150.0 $\pm$ 10%	1V / 100K	620	0.45
PSB0605181KZF	180.0 $\pm$ 10%	1V / 100K	690	0.40
PSB0605221KZF	220.0 $\pm$ 10%	1V / 100K	890	0.38
PSB0605271KZF	270.0 $\pm$ 10%	1V / 100K	1000	0.35
PSB0605331KZF	330.0 $\pm$ 10%	1V / 100K	1400	0.32
PSB0605391KZF	390.0 $\pm$ 10%	1V / 100K	1500	0.30
PSB0605471KZF	470.0 $\pm$ 10%	1V / 100K	2000	0.28
PSB0605561KZF	560.0 $\pm$ 10%	1V / 100K	2300	0.25
PSB0605681KZF	680.0 $\pm$ 10%	1V / 100K	3200	0.20
PSB0605821KZF	820.0 $\pm$ 10%	1V / 100K	3500	0.18
PSB0605102KZF	1000.0 $\pm$ 10%	1V / 100K	4100	0.16



**RoHS Compliant**

NOTE : Specifications subject to change without notice. Please check our website for latest information.

06.01.2015



**SUPERWORLD ELECTRONICS (S) PTE LTD**

## 7. CHARACTERISTICS CURVES :

@ TEMP. RISE VS. DC SUPERPOSITION RESPONSE CURVE

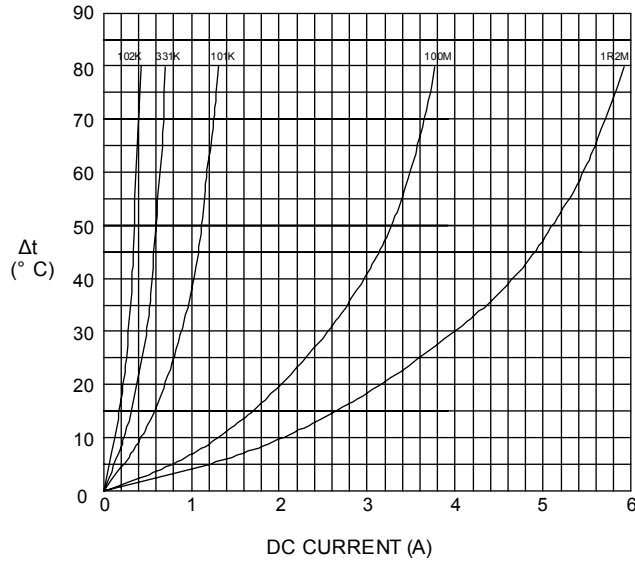

@ INDUCTANCE VS. FREQUENCY RESPONSE CURVE

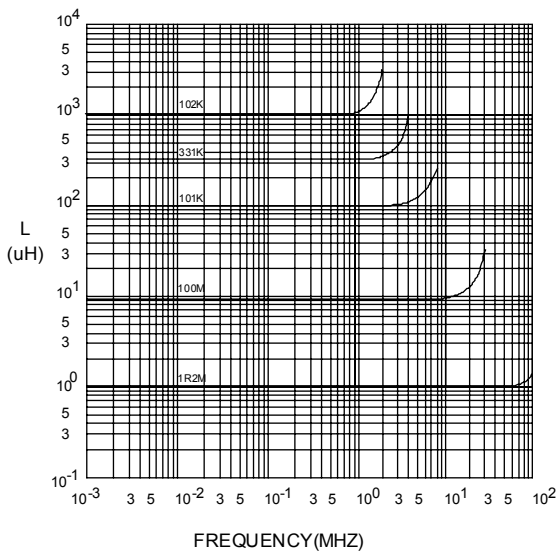

@ INDUCTANCE VS. DC SUPERPOSITION RESPONSE CURVE

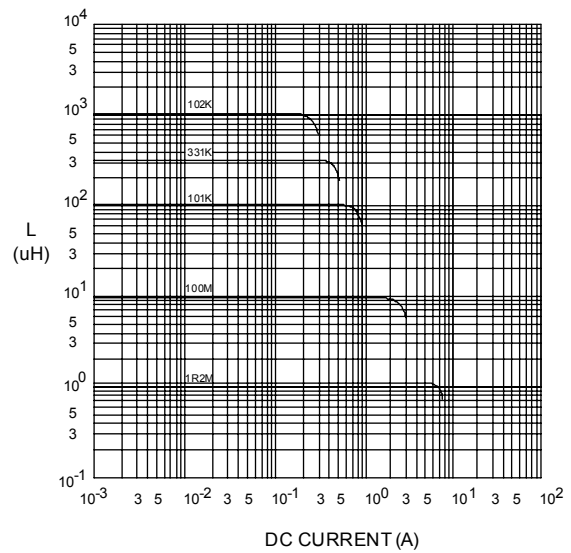

NOTE : Specifications subject to change without notice. Please check our website for latest information.



**RoHS Compliant**

06.01.2015



**SUPERWORLD ELECTRONICS (S) PTE LTD**

### RECOMMENDED SOLDERING CONDITIONS REFLOW SOLDERINGS

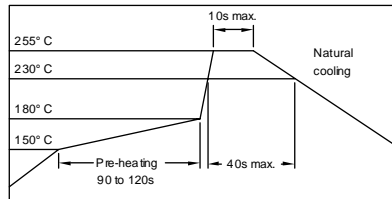

### 8. PACKAGING INFORMATION :

#### ( 1 ) CONFIGURATION

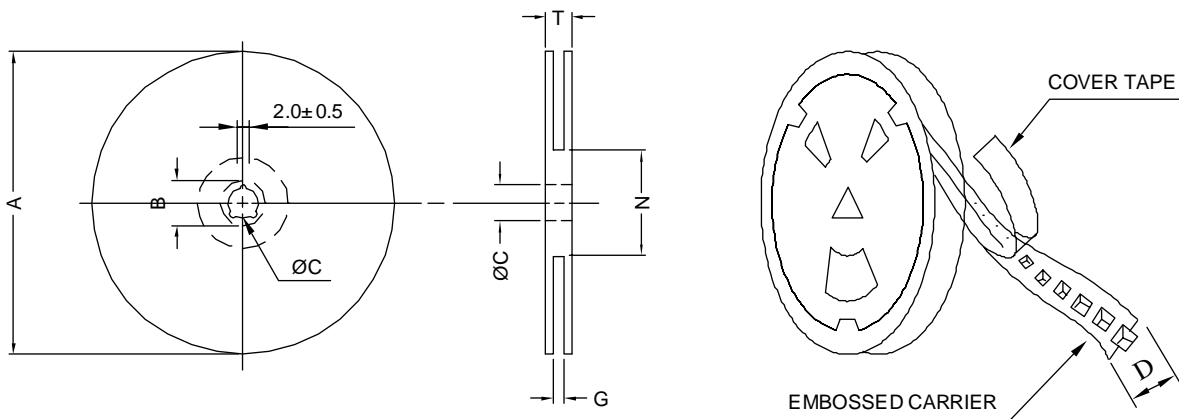

\* CARRIER TAPE WIDTH : D

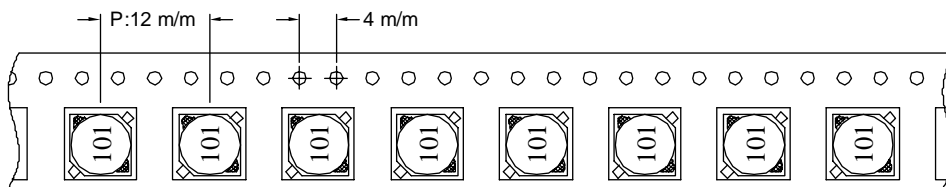

#### ( 2 ) DIMENSIONS

Unit:m/m

STYLE	A	B	C	D	G	N	T
13-16	330	21±0.8	13	16	18 <sup>+0</sup>	50 <sup>-0</sup>	22.4

#### ( 3 ) QTY & G.W. PER PACKAGE

SERIES	INNER : REEL			OUTER : CARTON		
	QTY (PCS)	G.W. (gw)	STYLE	QTY (PCS)	G.W. (Kg)	SIZE (cm)
PSB0605	1000	700	13-16	6000	7.7	40 x 40 x 24



**RoHS Compliant**

NOTE : Specifications subject to change without notice. Please check our website for latest information.

