

1. Part No. Expression:

PSB0602101MZF

(a) (b) (c) (d) (e)(f)

- (a) Series Code
- (b) Dimension Code
- (c) Induction Code
- (d) Tolerance Code
- (e) Standard Code
- (f) RoHS Code

2. Configuration & Dimensions

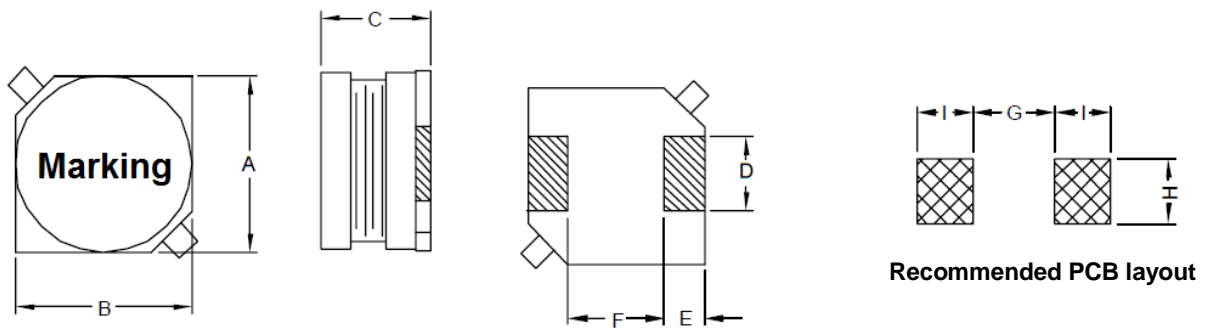

Marking: Inductance code

Unit: mm

A	B	C	D	E	F	G	H	I
6.0±0.3	6.0±0.3	2.5 Max.	2.0±0.2	1.5±0.2	3.0±0.2	2.8 Ref.	2.2 Ref.	1.9 Ref.

3. Schematic

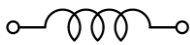

4. Material List

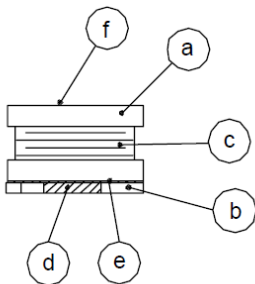

- (a) Core
- (b) Base
- (c) Wire
- (d) Terminal
- (e) Adhesive
- (f) Ink

5. General Specification

- a) Heat Rated Current at IDC will cause the coil temperature rise (ΔT) at 40°C Max.
- b) Saturation Current at IDC will cause an inductance ($\Delta L/L0A$) drop 10% Max.
- c) Operating Temperature: - 40 ~ +85°C
- d) Storage Temperature: - 40 ~ +85°C (on board)

6. Electrical Characteristics

Part No.	Inductance (μH)	Test Frequency (Hz)	RDC ($m\Omega$) Max.	IDC (A)
PSB06021R0MZF	1.0 \pm 20%	1V/100K	25	2.70
PSB06021R5MZF	1.5 \pm 20%	1V/100K	35	2.50
PSB06022R2MZF	2.2 \pm 20%	1V/100K	40	2.00
PSB06023R3MZF	3.3 \pm 20%	1V/100K	50	1.50
PSB06024R7MZF	4.7 \pm 20%	1V/100K	70	1.45
PSB06026R8MZF	6.8 \pm 20%	1V/100K	95	1.10
PSB0602100MFZ	10.0 \pm 20%	1V/100K	135	0.90
PSB0602150MZF	15.0 \pm 20%	1V/100K	190	0.75
PSB0602220MZF	22.0 \pm 20%	1V/100K	250	0.60
PSB0602330MZF	33.0 \pm 20%	1V/100K	350	0.50
PSB0602470MZF	47.0 \pm 20%	1V/100K	530	0.40
PSB0602680MZF	68.0 \pm 20%	1V/100K	700	0.30
PSB0602101MZF	100.0 \pm 20%	1V/100K	1050	0.25
PSB0602151MZF	150.0 \pm 20%	1V/100K	1650	0.20
PSB0602221MZF	220.0 \pm 20%	1V/100K	2200	0.18
PSB0602331MZF	330.0 \pm 20%	1V/100K	3300	0.15
PSB0602471MZF	470.0 \pm 20%	1V/100K	5300	0.12
PSB0602681MZF	680.0 \pm 20%	1V/100K	6900	0.11
PSB0602102MZF	1000.0 \pm 20%	1V/100K	10000	0.09

7. Characteristics Curves

TEMPERATURE RISE vs. DC CURRENT

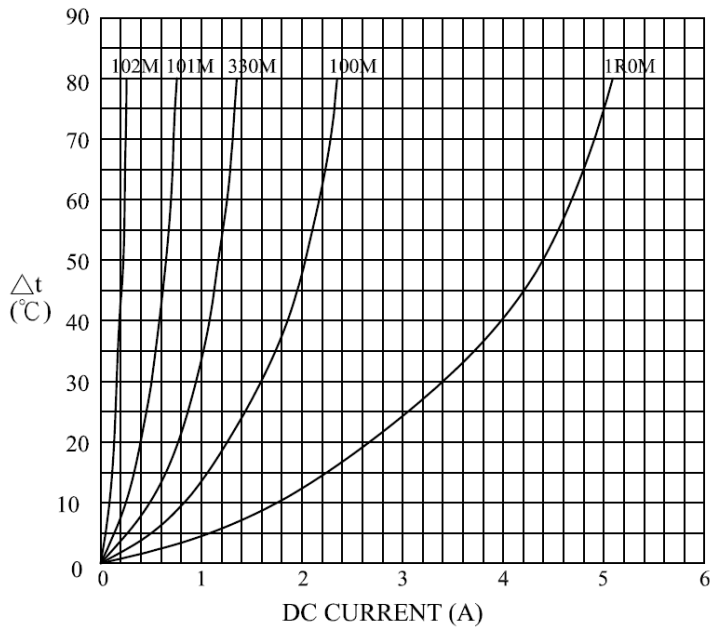

INDUCTANCE vs. FREQUENCY

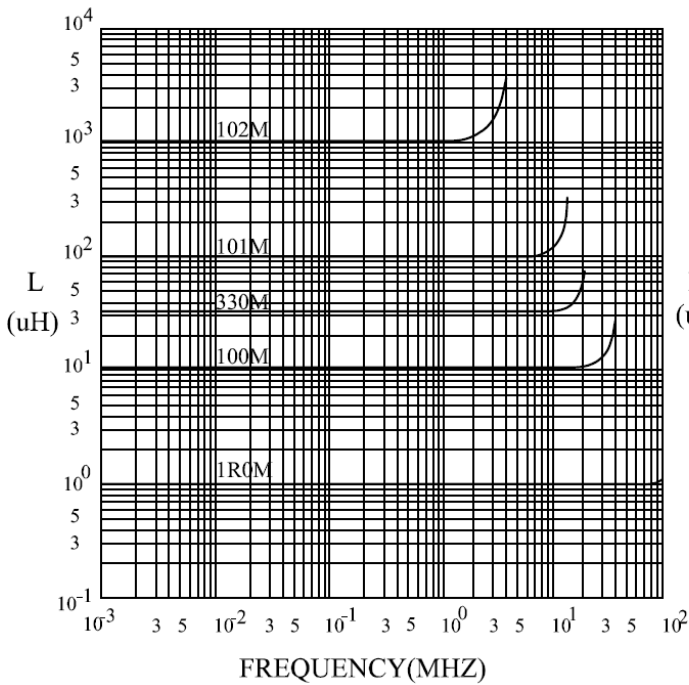

INDUCTANCE vs. DC CURRENT

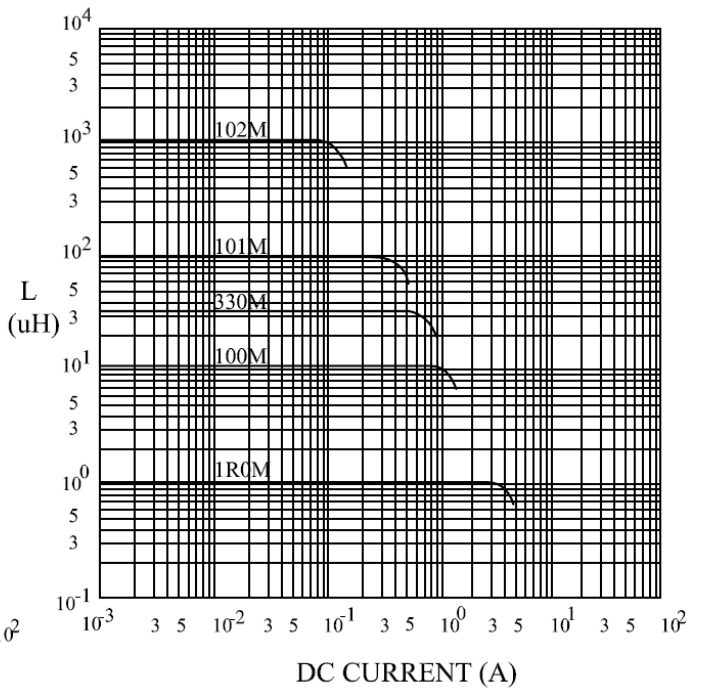

8. Packaging Information

8-1. Reel Dimension

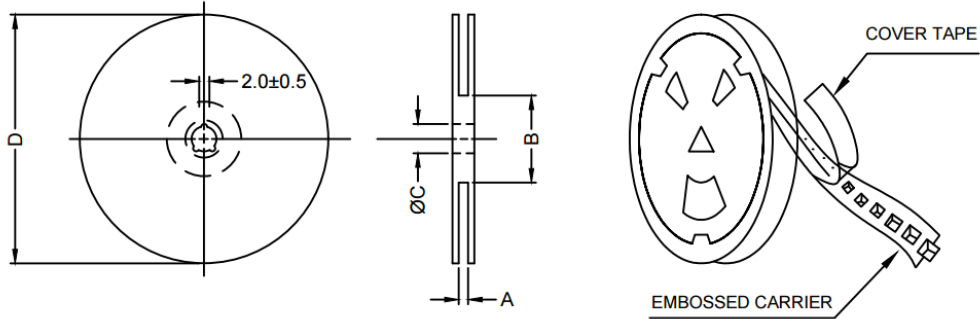

Type	A (mm)	B (mm)	C (mm)	D (mm)	G (mm)	N (mm)	T (mm)
13" x 16mm	330	21.0 ± 0.8	13	16	18	50	22.4

8-2. Tape Dimension

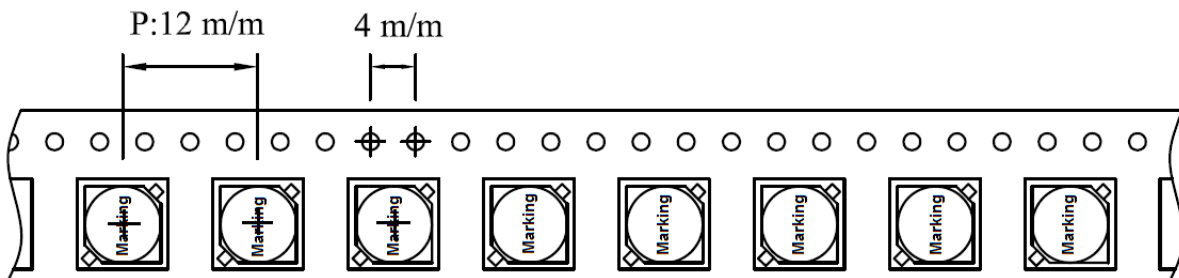

8-3. Packaging Quantity

Series	Inner reel		Outer carton		
	Quantity (pcs)	G.W (g)	Quantity (pcs)	G.W (Kg)	Size (cm)
PSB0602	1500	540	9000	6.8	40x40x24