

### 1. PART NO. EXPRESSION :

P D H 3 3 1 6 R 3 3 M Z F  
 (a) (b) (c) (d)(e)(f)

(a) Series code

(b) Dimension code

(c) Inductance code : R33 = 0.33uH

(d) Tolerance code : M = ± 20%

(e) Z : Standard part

(f) F : RoHS Compliant

### 2. CONFIGURATION & DIMENSIONS :

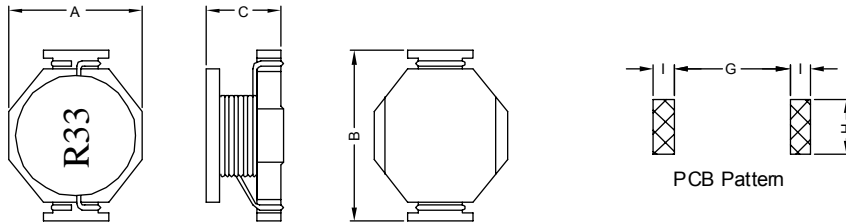

Unit:m/m

A	B	C	G	H	I
9.91 Max.	13.50 Max.	6.35 Max.	8.64 Ref.	4.06 Ref.	1.52 Ref.

### 3. SCHEMATIC :

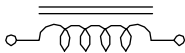

### 4. MATERIALS :

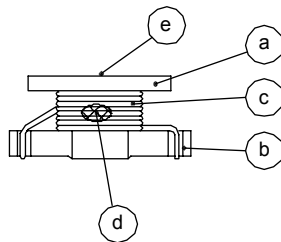

(a) Core

(b) Base

(c) Wire

(d) Adhesive

(e) Ink

### 5. GENERAL SPECIFICATION :

a) Temp. rise : 40° C Typ.

b) Isat : ΔL/L0A = 10% Typ.

c) Operating temp. : -40° C to +85° C

d) Storage condition (component in its packaging)

i) Temperature : -10 to 40° C

ii) Humidity : 60%

e) Resistance to solder heat : 260° C.10 secs



**RoHS Compliant**

NOTE : Specifications subject to change without notice. Please check our website for latest information.

25.11.2014



**SUPERWORLD ELECTRONICS (S) PTE LTD**

## 6. ELECTRICAL CHARACTERISTICS :

Part No.	Inductance ( $\mu$ H)	Test Freq. ( Hz )	SRF ( MHz ) Typ.	RDC ( m $\Omega$ ) Max.	Isat ( A )	Irms ( A )
PDH3316R33MZF	0.33 $\pm$ 20%	0.1V/100K	300	2	20.0	16.0
PDH3316R68MZF	0.68 $\pm$ 20%	0.1V/100K	200	5	13.0	12.0
PDH33161R0MZF	1.00 $\pm$ 20%	0.1V/100K	100	6	11.0	10.0
PDH33161R5MZF	1.50 $\pm$ 20%	0.1V/100K	90	8	9.0	9.0
PDH33162R2MZF	2.20 $\pm$ 20%	0.1V/100K	90	11	7.8	7.4
PDH33162R7MZF	2.70 $\pm$ 20%	0.1V/100K	65	12	7.0	6.6
PDH33163R3MZF	3.30 $\pm$ 20%	0.1V/100K	65	14	6.4	5.9
PDH33164R7MZF	4.70 $\pm$ 20%	0.1V/100K	45	18	5.4	4.8
PDH33165R6MZF	5.60 $\pm$ 20%	0.1V/100K	40	22	5.0	4.6
PDH33166R8MZF	6.80 $\pm$ 20%	0.1V/100K	36	27	4.6	4.4
PDH33168R2MZF	8.20 $\pm$ 20%	0.1V/100K	28	32	4.0	4.0
PDH3316100MZF	10.00 $\pm$ 20%	0.1V/100K	25	38	3.8	3.9



RoHS Compliant

NOTE : Specifications subject to change without notice. Please check our website for latest information.

25.11.2014



SUPERWORLD ELECTRONICS (S) PTE LTD

## 7. CHARACTERISTICS CURVES :

@ TEMP. RISE VS. DC SUPERPOSITION RESPONSE CURVE

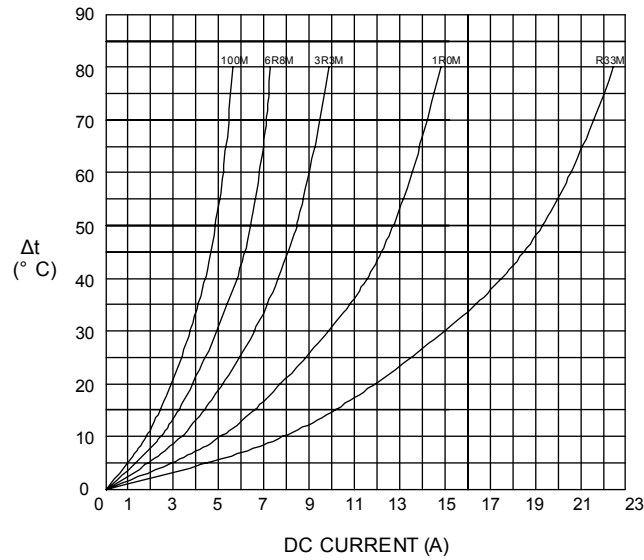

@ INDUCTANCE VS. FREQUENCY RESPONSE CURVE

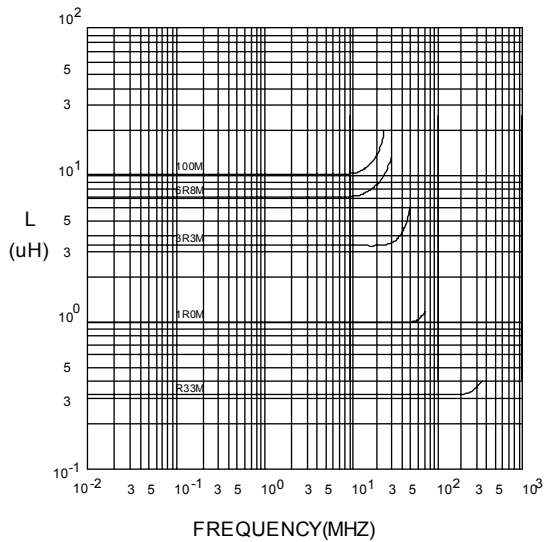

@ INDUCTANCE VS. DC SUPERPOSITION RESPONSE CURVE

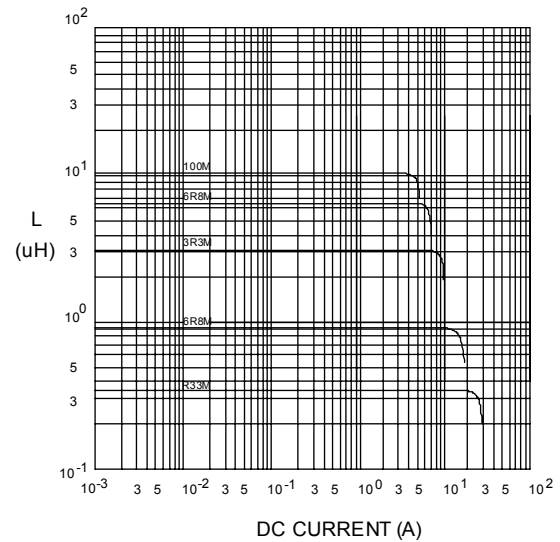

NOTE : Specifications subject to change without notice. Please check our website for latest information.



RoHS Compliant

25.11.2014



SUPERWORLD ELECTRONICS (S) PTE LTD

### RECOMMENDED SOLDERING CONDITIONS REFLOW SOLDERINGS

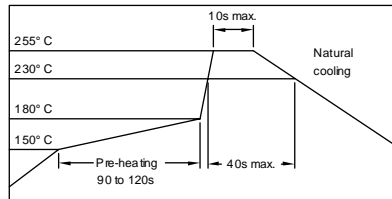

### 8. PACKAGING INFORMATION :

#### ( 1 ) CONFIGURATION

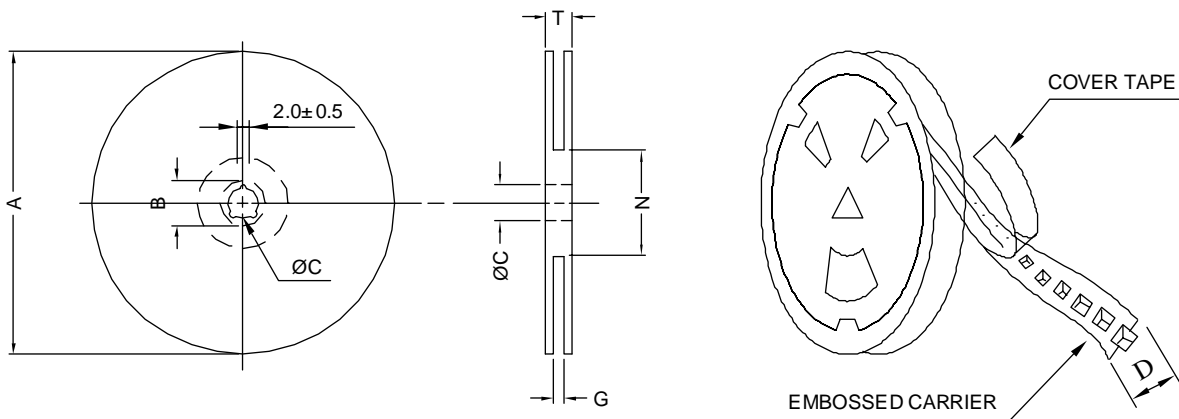

\* CARRIER TAPE WIDTH : D

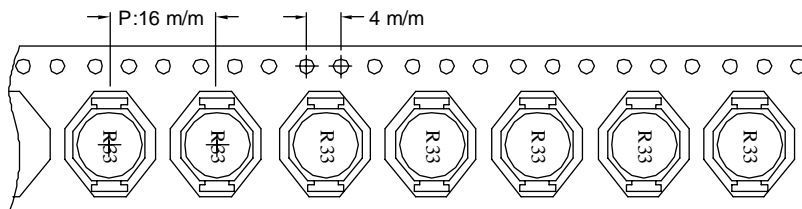

#### ( 2 ) DIMENSIONS

Unit:m/m

STYLE	A	B	C	D	G	N	T
13-24	330	21±0.8	13±0.5	24	26 <sup>+0</sup>	50 <sup>-0</sup>	30.4

#### ( 3 ) QTY & G.W. PER PACKAGE

SERIES	INNER : REEL			OUTER : CARTON		
	QTY (PCS)	G.W. (gw)	STYLE	QTY (PCS)	G.W. (Kg)	SIZE (cm)
PDH3316	600	1100	13-24	2400	7.9	40 x 40 x 24



**RoHS Compliant**

NOTE : Specifications subject to change without notice. Please check our website for latest information.

25.11.2014



**SUPERWORLD ELECTRONICS (S) PTE LTD**